



# 2018 ROAD MAP

## for Early Career Professionals



**ATS 2018**  
*Where today's science  
meets tomorrow's care™*

May 18-May 23, 2018  
San Diego, CA  
[conference.thoracic.org](http://conference.thoracic.org)

# RETHINK HEALTH CARE

We've expanded our master's degree options to meet the growing challenges within integrated health care. Through experiential and problem based-learning you will obtain the necessary skills to lead within diverse health sectors.

- Health Services Administration
- Public Health
- Dual Enrollment: Master of Health Services Administration and Master of Public Health

For questions about admission or program offerings, contact us at 800.721.8072 or [thechicagoschool.edu](http://thechicagoschool.edu)



**TheChicagoSchool**<sup>®</sup>  
of Professional Psychology

## CONTENTS

Welcome Letter .....	2
Networking Exchange for Early Career Professionals.....	3
Roadmap Schedule .....	4
Important Events for Early Career Professionals .....	8
The ATS at a Glance.....	9
ATS Assemblies Mentorship Programs .....	10
ATS Assembly Membership Meetings .....	11
Journal Opportunities for Early Career Professionals .....	12
Center for Career Development Schedule of Events .....	13
ATS Faculty Development Series .....	14
Diversity Forum & Women’s Forum .....	15
BEAR Cage .....	16
Science & Innovation Center .....	17
Get Social .....	18
Global Health Careers / SIC Reception .....	19
Did you know?.....	20
San Diego Convention Center Map.....	21

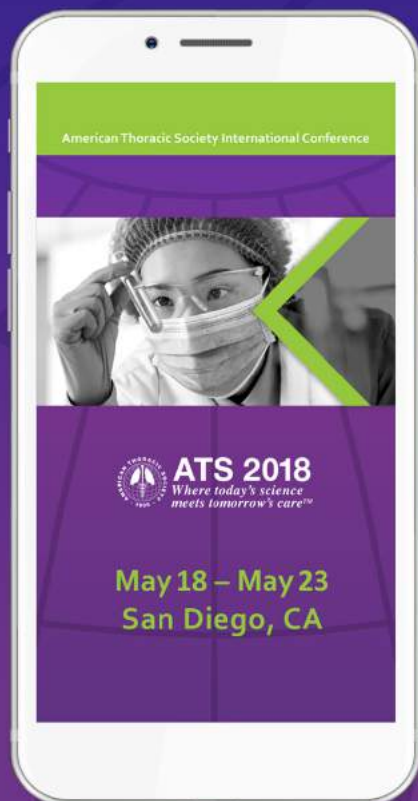

**For conference info at your fingertips, look for the ATS 2018 Conference App in the App Store or Google Play!**

**DOWNLOAD  
THE APP HERE**





Jeremy Richards, MD, MA  
Chair, MITT Committee

Welcome to ATS 2018 in San Diego, CA! With more than 15,000 attendees from more than 100 countries, ATS 2018 is one of the largest gatherings of pulmonary, critical care, and sleep medicine professionals in the world. The Members In Transition and Training (MITT) Committee understand that the ATS conference can be daunting to navigate, which is why we created the Road Map for Early Career Professionals.

The Road Map is a flowsheet of all the major events at ATS 2018. You will see that members of the MITT Committee have highlighted activities of particular interest to early career professionals. In addition to using the Road Map to navigate major sessions, you should search the entire ATS conference program for research symposia and poster sessions related to your specific interests, and we highly encourage you to attend these sessions.

In the Road Map, we have also highlighted several events, programs, resources and tools that are of particular interest to residents, fellows, and early career professionals:

- **Center for Career Development (CCD):** You should stop by the Center for Career Development! The CCD is a networking forum where senior clinicians and researchers offer advice on different aspects of career development for clinicians, clinician educators, researchers, and more. Check out the schedule for the CCD and come to the sessions that seem most interesting to you!
- **ATS at a Glance:** In the Road Map, we offer a brief written overview of how the ATS is structured as an organization, and highlight opportunities to get involved. In addition, there will be a live session in the Center for Career Development on Sunday, May 20th from 11AM-12PM to review tips and strategies to help you navigate the conference.
- **Assembly Business Meetings:** We strongly believe that the Assembly business meetings are the best way to get involved in the ATS. More information about the ATS Assemblies can be found on page 10.
- **Adult and Pediatric Core Curriculum Sessions:** ATS 2018 features a core curriculum that showcases adult and pediatric medicine that corresponds with online modules submitted to the ABIM and ABP for MOC.
- **Grant Resource Guide:** A comprehensive list of funding sources specific for fellows & early career faculty will be available in the Center for Career Development.

The Grant Resource Guide is also online at:

<https://www.thoracic.org/professionals/career-development/grant-resource-guide.php>

There are many ways to get involved with in the ATS. In addition to participating in the Assemblies, there are many committees, task forces, and opportunities to advocate for improved health care for patients and increased funding for research. If you are interested in getting more involved, please contact ATS staff members Elizabeth Guzman and Odalys Jimenez, who work closely with the MITT Committee at [fellows@thoracic.org](mailto:fellows@thoracic.org).

Again, welcome to ATS 2018! We hope you have an exciting and informative experience.

Sincerely,

Jeremy Richards, MD, MA  
Chair, MITT Committee

## THE NETWORKING EXCHANGE FOR EARLY CAREER PROFESSIONALS

Become an  
ATS member  
for FREE!

Connect  
with  
Peers!

Get  
involved!

Learn more  
about  
the ATS  
conference!

COME MINGLE WITH COLLEAGUES, MENTORS AND PEERS  
COMPLIMENTARY DRINKS AND APPETIZERS

**Saturday, May 19, 2018**

**Time: 5:30 - 6:30 p.m.**

**Location: Marriott Marquis San Diego Marina,  
Pacific Ballroom Foyer (North Tower, First Floor)**

The event is FREE to paid conference registrant.

Sponsored by The Membership and Training Committee (MITT)

Questions? Contact Liz Guzman ([lguzman@thoracic.org](mailto:lguzman@thoracic.org)) or Odalys Jimenez ([ojimenez@thoracic.org](mailto:ojimenez@thoracic.org))

**Connect with Us! Use #ATSEarlyCareer**



**ATS 2018**  
*Where today's science  
meets tomorrow's care™*

San Diego, CA  
May 18 - May 23, 2018  
[conference.thoracic.org](http://conference.thoracic.org)

# ROAD MAP DAILY SCHEDULE

## Sunday, May 20

Highlighted sessions are recommended by MITT for early career professionals.

### Morning Sessions

Session Code	Title	Focus	Room
Early Morning Session Time: 7:00 - 8:00 a.m.			
PCC1	CYSTIC FIBROSIS		Room 1 A-B (Upper Level): CC
8:15 a.m. - 9:00 a.m.			
K1	ATS Keynote Series		Room 6 B (Upper Level) : CC
K2	ATS Keynote Series		Room 6 C/F (Upper Level): CC
Morning Session Time: 9:15 - 11:15 a.m.			
A1	CLINICAL YEAR IN REVIEW 1 ILD, Pulmonary Rehabilitation, Lung Transplantation, Interventional Pulmonology		Hall H (Ground Level): CC
A2	NEJM/JAMA Session: Pulmonary TBD		Room 29 A-D (Upper Level): CC
A3	FELLOWS CASE CONFERENCE	Clinical	Ballroom 20 D (Upper Level): CC
A4	SURVIVING CRITICAL ILLNESS: OPTIMIZING OUTCOMES IN THE POST-ICU SPACE	Clinical	Ballroom 20 A (Upper Level): CC
A5	Top/Down Symposium TBD		Pacific Ballroom 21 (North Tower, First Floor): MM
A6	GLYCOBIOLOGY AND GLYCOMICS OF LUNG DISEASES	Basic, Translational	Pacific Ballroom 21 (North Tower, First Floor): MM
A7	LEVERAGING MOLECULAR MECHANISMS OF GRANULOMA FORMATION IN SARCOIDOSIS TO IMPROVE CARE	Basic, Clinical, Translational	Ballroom 20 B-C (Upper Level) : CC
A8	CURRENT CONTROVERSIES IN PAH DISEASE MECHANISMS: A PRO/CON DEBATE	Basic, Translational	Room 15 A-B (Mezzanine Level): CC
A9	ACCELERATING SCIENTIFIC ADVANCEMENT OF RARE PEDIATRIC LUNG DISEASES	Basic, Clinical, Translational	Room 7 A-B (Upper Level): CC
A10	PATHOBIOLOGY OF AGE-RELATED LUNG DISEASE: FROM BENCH TO BEDSIDE	Basic, Clinical, Translational	Pacific Ballroom 22 (North Tower, First Floor): MM
A11	ATS/JRS/CTS/ERS SYMPOSIUM ON SEVERE ASTHMA: RATIONALIZING TARGETED THERAPEUTICS	Basic, Clinical, Translational	Room 6 A (Upper Level): CC
A12	FROM SPANISH FLU OF 1918 TO TODAY: LESSONS LEARNT FROM VIRUSES	Basic, Clinical, Translational	Room 6 A (Upper Level): CC
A13	ATS/ALA IMPLEMENTATION GUIDE FOR LUNG CANCER SCREENING: AN OPERATIONAL TOOLKIT	Behavioral, Clinical, Translational	Room 16 A-B (Mezzanine Level): CC
Mid-Afternoon Session Time: 11:45 a.m. - 1:15 p.m.			
CC1	SLEEP MEDICINE CLINICAL CORE CURRICULUM: Hypersomnia, Narcolepsy		Room 16 A-B (Mezzanine Level): CC

### Afternoon Sessions

Session Code	Title	Focus	Room
Afternoon Session Times: 2:15p.m. - 4:15p.m.			
A81	PEDIATRIC YEAR IN REVIEW	Basic, Clinical, Translational	Room 6 B (Upper Level): CC
A82	REACHING FOR THE GOLD: ADDRESSING GAPS IN THE CURRENT GOLD GUIDELINES	Clinical	Ballroom 20 B-C (Upper Level): CC
A83	GREAT CASES: CLINICAL, RADIOLOGIC, AND PATHOLOGIC CORRELATIONS BY MASTER PHYSICIANS	Clinical	Ballroom 20 D (Upper Level): CC
A84	NEJM/JAMA Session: Critical Care TBD		Room 29 A-D (Upper Level): CC
A85	MITOCHONDRIAL DYSFUNCTION AND REPROGRAMMING IN LUNG AGING AND DISEASE		Pacific Ballroom 21 (North Tower, First Floor): MM
A86	ATS MYTHBUSTERS: BIOENGINEERING APPROACHES WILL REVOLUTIONIZE RESPIRATORY MEDICINE IN THE NEXT TEN YEARS	Basic, Translational	Pacific Ballroom 18-19 (North Tower, First Floor): MM
A87	MECHANISMS OF PERSISTENT ORGAN DYSFUNCTION AFTER CRITICAL ILLNESS	Translational	Ballroom 20 A (Upper Level): CC
A88	CPAP AND WEIGHT GAIN: MECHANISMS AND BEYOND	Basic, Behavioral, Clinical, Translational	Room 7 A-B (Upper Level): CC
A89	EMERGING CONCEPTS IN CHRONIC THROMBOEMBOLIC PULMONARY HYPERTENSION	Clinical	Room 15 A-B (Mezzanine Level): CC
A90	CRACKING THE VACCINE CODE IN TB: INNATE IMMUNITY	Basic, Clinical, Translational	Grand Ballroom 8-9 (North Tower, Lobby Level): MM
A91	REDUCING DISPARITIES IN ENVIRONMENTAL LUNG DISEASE: EMERGING METHODS IN EXPOSURE MITIGATION	Clinical, Translational	Room 30 A-B (Upper Level): CC
A92	FROM PRINCIPLES TO PRACTICE: EXPLORING MECHANISTIC KNOWLEDGE TO ADVANCE CLINICAL CARE		Room 33 A-C (Upper Level): CC

CC: San Diego Convention Center MM: Marriott Marquis San Diego Marina



# ROAD MAP DAILY SCHEDULE

## Monday, May 21

Highlighted sessions are recommended by MITT for early career professionals.

### Morning Sessions

Session Code	Title	Focus	Room
Early Morning Session Time: 7:00 - 8:00 a.m.			
PCC2	Pediatric Clinical Core Curriculum: Neuromuscular Disorders, Children with SMA and DMD		Room 1 A-B (Upper Level): CC
8:15 AM - 9:00 AM			
K3	ATS Keynote Series		Room 6 B (Upper Level): CC
K4	ATS Keynote Series		Room 6 C/F (Upper Level): CC
Morning Session Time: 9:15 - 11:15 a.m.			
B1	CLINICAL YEAR IN REVIEW 2: COPD, Asthma, Lung Cancer, Health Disparities		Hall H (Ground Level): CC
B2	INTERSTITIAL LUNG DISEASES (ILD), IDIOPATHIC INTERSTITIAL PNEUMONIA (IIP) AND HYPERSENSITIVITY PNEUMONITIS(HP): CONTROVERSIES IN MANAGEMENT. PRO/CON DEBATE	Behavioral, Clinical, Translational	Ballroom 20 B-C (Upper Level): CC
B3	THE REVOLUTION OF LUNG IMAGING: FROM PIXELS TO PATIENTS	Clinical	Ballroom 20 D (Upper Level): CC
B4	TARGETS FOR IMPROVED SEPSIS CARE: WHAT, WHEN, AND HOW	Behavioral, Clinical, Translational	BALLROOM 20 A (UPPER LEVEL): CC
B5	MITOCHONDRIA AND NUCLEAR-DERIVED DANGER-ASSOCIATED MOLECULAR PATTERNS (DAMPS) IN PULMONARY DISEASES	Basic, Translational	Pacific Ballroom 21 (North Tower, First Floor): MM
B6	PRINCIPLES TO PRACTICE IN PULMONARY REHABILITATION: A PRO/CON DEBATE	Basic, Behavioral, Clinical, Translational	Room 16 A-B (Mezzanine Level) : CC
B7	GENETICS, EPIGENETICS, AND GENOMICS OF CHILDHOOD LUNG DISEASES	Basic, Clinical, Translational	Room 1 A-B (Upper Level): CC
B8	NONTUBERCULOUS MYCOBACTERIA INFECTION: CURRENT KNOWLEDGE AND RECENT ADVANCES	Clinical	Grand Ballroom 8-9 (North Tower, Lobby Level): MM
B9	TH17 CELLS: FRIEND, FOE OR BOTH IN CHRONIC LUNG DISEASES	Basic, Translational	Grand Ballroom 5-6 (North Tower, Lobby Level): MM
B10	LUNG CANCER SCREENING: WHO'S IN AND WHO'S OUT? A PRO/CON DEBATE	Behavioral, Clinical, Translational	Room 32 A-B (Upper Level): CC
B11	FROM E-CIGARETTES TO MARIJUANA: ADDICTION IN PULMONARY AND CRITICAL CARE MEDICINE	Basic, Behavioral, Clinical, Translational	Room 14 A-B (Mezzanine Level): CC
B12	GLOBAL CARE FOR SLEEP DISORDERS: TOWARDS UNIVERSAL ACCESS	Clinical	Room 7 A-B (Upper Level): CC
B13	METACOGNITION IN MEDICINE: UNDERSTANDING HOW THE MIND WORKS TO IMPROVE TEACHING, LEARNING, AND PATIENT CARE		Room 3 (Upper Level): CC
Mid-Afternoon Session Times: 11:45 a.m. - 1:15 p.m.			
CC2	CRITICAL CARE CLINICAL CORE CURRICULUM: Neurology		Hall E (Middle Building, Level 2), CC

### Afternoon Sessions

Session Code	Title	Focus	Room
2:15 PM - 4:15 PM			
CC3	SLEEP MEDICINE CLINICAL CORE CURRICULUM RLS, REM, Sleep Disorders, Sleep Neurologic Disorders, Sleep Neurologic Disease		Hall H (Ground Level): CC
B81	NURSING YEAR IN REVIEW	Behavioral, Clinical, Translational	Room 30 A-B (Upper Level): CC
B82	CONTROVERSIES IN THE DIAGNOSIS AND TREATMENT OF COPD	Basic, Clinical, Translational	Ballroom 20 B-C (Upper Level): CC
B83	THE OTHER (NON-SMALL CELL LUNG CANCER) THORACIC MALIGNANCIES	Clinical	Room 1 A-B (Upper Level): CC
B84	SIX CONTROVERSIES IN FLUID ADMINISTRATION IN SEPSIS	Clinical, Translational	Ballroom 20 A (Upper Level): CC
B85	IMMUNOMETABOLISM: THE COMPLEX INTERPLAY BETWEEN METABOLIC REPROGRAMMING & IMMUNITY	Basic	Pacific Ballroom 21 (North Tower, First Floor): MM
B86	FIRING ON ALL CYLINDERS: OPTIMIZING CRITICAL CARE DELIVERY AND IMPROVING OUTCOMES	Behavioral, Clinical	Room 33 A-C (Upper Level): CC
B87	PAYING TOO HIGH A PRICE! THE LUNG HEALTH COST OF ENERGY EXTRACTION	Clinical, Translational	Room 7 A-B (Upper Level): CC
B88	JUST DO IT: REDUCING PEDIATRIC RESPIRATORY HEALTH DISPARITIES	Behavioral, Clinical, Translational	Room 6 B (Upper Level): CC
B89	NOT JUST THE LUNGS: PAH AS A SYSTEMIC VASCULAR DISORDER	Basic, Translational	Grand Ballroom 5-6 (North Tower, Lobby Level): MM
B90	RAPID MOLECULAR DIAGNOSTICS FOR PNEUMONIA: IS SPEED THE ONLY THING?	Clinical	Grand Ballroom 8-9 (North Tower, Lobby Level): MM
B91	AT THE INTERFACE OF ENGINEERING AND RESPIRATORY MEDICINE: UPDATES AND APPLICATIONS	Basic, Translational	Pacific Ballroom 18-19 (North Tower, First Floor): MM
B92	AJRCCM in 2018	Basic, Clinical, Translational	Ballroom 20 D (Upper Level): CC



**ATS 2018**  
Where today's science  
meets tomorrow's care™

San Diego, CA  
May 18 - May 23, 2018  
conference.thoracic.org

# ROAD MAP DAILY SCHEDULE

## Tuesday, May 22

Highlighted sessions are recommended by MITT for early career professionals.

### Morning Sessions

Session Code	Title	Focus	Room
Early Morning Session Time: 7:00 - 8:00 a.m.			
PCC3	Pediatric Clinical Core Curriculum: Dysphagia/Aspiration, Children with Aerodigestive Disorders		Room 1 A-B (Upper Level): CC
8:15 - 9:00 a.m.			
K5	ATS Keynote Series		Room 6 B (Upper Level): CC
K6	ATS Keynote Series		Room 6 B (Upper Level): CC
Morning Session Time: 9:15 - 11:15 a.m.			
C1	CLINICAL YEAR IN REVIEW 3: Genomics and Precision Medicine in Lung Disease, ARDS, Cystic Fibrosis, Sleep Disordered Breathing		Hall H (Ground Level): CC
C2	INTERSTITIAL LUNG DISEASE FROM CRADLE TO GRAVE	Clinical	Ballroom 20 B-C (Upper Level): CC
C3	STATE OF THE ART PLEURAL DISEASE MANAGEMENT: CLINICAL TRIALS CHANGING CARE PRACTICE	Clinical	Ballroom 20 D (Upper Level): CC
C4	MODERN DILEMMAS IN CRITICAL CARE: WHY A LITTLE BIT OF KNOWLEDGE CAN BE A DANGEROUS THING	Behavioral, Clinical	Ballroom 20 A (Upper Level): CC
C5	MITOCHONDRIA-TARGETED THERAPEUTICS FOR PREVENTING OR TREATING LUNG DISEASES	Basic	Pacific Ballroom 21 (North Tower, First Floor) : MM
C6	COPD PROGRESSION: CULPRITS AND MODIFIERS	Basic, Translational	Pacific Ballroom 18-19 (North Tower, First Floor): MM
C7	MEDICATION AND BEYOND: TARGETED SYMPTOM MANAGEMENT FOR THE MECHANICALLY VENTILATED PATIENT	Clinical, Translational	Room 30 A-B (Upper Level): CC
C8	TRANSLATIONAL IMMUNOLOGY AND LUNG DISEASE: INTEGRATING PATHOBIOLOGY TO THERAPY	Basic, Clinical, Translational	Grand Ballroom 5-6 (North Tower, Lobby Level): MM
C9	MAKING TUBERCULOSIS PREVENTION GREAT AGAIN	Clinical, Translational	Grand Ballroom 8-9 (North Tower, Lobby Level): MM
C10	NOVEL STRATEGIES TO COMPLEMENT PULMONARY REHABILITATION IN COPD	Clinical	Room 16 A-B (Mezzanine Level): CC
C11	NEW PARADIGMS FOR RESOLVING SLEEP APNEA HETEROGENEITY: DEEP PHENOTYPING AND GENOMICS	Translational	Room 7 A-B (Upper Level) : CC
C12	CHOOSING RIGHTLY: AT THE INTERSECTION OF PERSONALIZED MEDICINE AND DE-ADOPTION OF LOW-VALUE CARE	Behavioral, Clinical	Room 14 A-B (Mezzanine Level): CC

### Afternoon Sessions

Session Code	Title	Focus	Room
Afternoon Session Times: 2:15 - 4:15 p.m.			
CC4	CRITICAL CARE CLINICAL CORE CURRICULUM: INFECTIOUS DISEASES		Hall H (Ground Level): CC
C82	SHIFTING FOCUS: HOW TO STUDY LUNG HEALTH INSTEAD OF DISEASE	Clinical, Translational	Ballroom 20 B-C (Upper Level): CC
C83	PEDIATRIC CLINICAL CHEST ROUNDS	Clinical	Ballroom 20 D (Upper Level) : CC
C84	MANAGING EARLY ACUTE HYPOXIC RESPIRATORY FAILURE	Behavioral, Clinical, Translational	Ballroom 20 A (Upper Level): CC
C85	SCIENTIFIC BREAKTHROUGHS: CELL FUNCTION, FATE AND FITNESS: ROLE OF MITOCHONDRIA	Basic, Translational	Pacific Ballroom 21 (North Tower, First Floor): MM
C86	RISE AND ALIGN! INTEGRATING MULTI-OMICS TECHNOLOGIES	Basic	Pacific Ballroom 18-19 (North Tower, First Floor): MM
C87	WHAT'S OLD IS NEW AGAIN: REPURPOSING APPROVED MEDICATIONS FOR NOVEL THERAPEUTICS IN PAH - EARLY CLINICAL STUDIES	Clinical, Translational	Pacific Ballroom 22 (North Tower, First Floor): MM
C88	YES, YOUR PULMONARY PATIENT IS READY FOR PALLIATIVE CARE	Clinical	Room 30 A-B (Upper Level): CC
C89	FUTURE RESPIRATORY HEALTH IN CHILDREN: CLIMATE CHANGE AND INCREASING WORLD POPULATION	Clinical	Room 6 C/F (Upper Level): CC
C90	SLEEP AND LUNG DISEASE: COMMON AND ILICIT BED PARTNERS	Basic	Room 1 A-B (Upper Level): CC
C91	HUMAN LUNG DEVELOPMENT: NEW TOOLS AND THERAPEUTIC STRATEGIES	Basic, Translational	Room 15 A-B (Mezzanine Level): CC
C92	DISEASE MODIFICATION IN COPD: ARE WE THERE YET?	Clinical	Room 33 A-C (Upper Level): CC
C93	ATS CLINICAL PRACTICE GUIDELINES: CLINICAL PRACTICE ON THE CUTTING EDGE	Behavioral, Clinical, Translational	Room 32 A-B (Upper Level): CC

CC: San Diego Convention Center MM: Marriott Marquis San Diego Marina





# ROAD MAP DAILY SCHEDULE

## Wednesday, May 23

Highlighted sessions are recommended by MITT for early career professionals.

### Morning Sessions

Session Code	Title	Focus	Room
Early Morning Session Time: 7:00- 8:00 a.m.			
PCC4	Pediatric Clinical Core Curriculum: Pulmonary Physiology		Room 6 A (Upper Level) : CC
8:15- 9:00 a.m.			
K7	ATS Keynote Series		Room 6 B (Upper Level) : CC
K8	ATS Keynote Series		Room 6 C/F (Upper Level): CC
Morning Session Time: 9:15 - 11:15 a.m.			
D1	CLINICAL YEAR IN REVIEW 3, General Critical Care, Critical Care Quality Improvement, Pleural Disease, Nosocomial Pneumonia		Hall H (Ground Level): CC
D2	UNDERSTANDING CHRONIC LUNG ALLOGRAFT DYSFUNCTION: UPDATE FROM THE BEDSIDE AND BENCH	Clinical, Translational	Ballroom 20 B-C (Upper Level) : CC
D3	WOMEN AND LUNG DISEASE	Clinical	Ballroom 20 D (Upper Level): CC
D4	EXTRACORPOREAL LIFE SUPPORT FOR RESPIRATORY FAILURE IN ADULTS: KEEPING PACE WITH THE DATA	Clinical	Ballroom 20 A (Upper Level): CC
D5	MECHANOBIOLOGY IN THE AIRWAY ENVIRONMENT: FEEL THE FORCE	Basic, Clinical, Translational	Pacific Ballroom 18-19 (North Tower, First Floor): MM
D6	MANIPULATING INFLAMMATORY AND EPITHELIAL NETWORKS FOR PREVENTION AND TREATMENT OF LUNG CANCER	Basic, Translational	Room 16 A-B (Mezzanine Level): CC
D7	FROM CANCER BIOLOGY TO NEW THERAPEUTICS: TARGETING CELL PROLIFERATION SIGNALING HUBS IN PULMONARY HYPERTENSION AND FIBROSIS	Basic, Clinical, Translational	Room 15 A-B (Mezzanine Level): CC
D8	UNRAVELING THE MYSTERIES OF THE MITOCHONDRIA IN PULMONARY INFLAMMATION/INJURY	Basic	Room 14 A-B (Mezzanine Level): CC
D9	CONTROVERSIES IN CLINICAL PEDIATRIC PULMONOLOGY	Clinical	Room 6 A (Upper Level): CC
D10	GROWING UP WITH CHRONIC PULMONARY DISEASE: CHALLENGES IN THE TRANSITION FROM PEDIATRIC TO ADULT FOCUSED HEALTH CARE	Behavioral, Clinical	Room 33 A-C (Upper Level): CC
D11	BATTLING BURNOUT: OVERCOMING THE BIGGEST THREAT TO HEALTH CARE QUALITY AND SAFETY		Room 1 A-B (Upper Level): CC
Early Afternoon Session Time: 11:45 am-1:15 pm			
CC5	PULMONARY CLINICAL CORE CURRICULUM: ILD, PARENCHYMAL LUNG DISEASES		Room 15 A-B (Mezzanine Level): CC

### Afternoon Sessions

Session Code	Title	Focus	Room
11:45 a.m. - 1:15 p.m.			
CC5	PULMONARY CLINICAL CORE CURRICULUM: ILD, PARENCHYMAL LUNG DISEASES		Room 15 A-B (Mezzanine Level): CC
1:30 - 3:30 p.m.			
CC6	PULMONARY CLINICAL CORE CURRICULUM Neuromuscular Disease, ILD, Occupational/Environmental Disease, Drug-Induced Lung Disease		Room 15 A-B (Mezzanine Level) : CC
D82	INTERVENTIONAL APPROACHES TO THE TREATMENT OF OBSTRUCTIVE LUNG DISEASES	Behavioral, Clinical, Translational	Ballroom 20 B-C (Upper Level) : CC
D83	CLINICAL TRIAL DESIGN IN IPF	Clinical, Translational	Ballroom 20 D (Upper Level): CC
D84	CRITICAL ILLNESS AND THE AGING BRAIN: DEMENTIA AND DELIRIUM IN THE ICU	Clinical, Translational	Ballroom 20 A (Upper Level) : CC
D85	HYPOGLOSSAL MOTONEURONS IN OSA: HOW TO FIX THE BROKEN ENGINE	Basic, Translational	Room 7 A-B (Upper Level) : CC
D86	INTERDISCIPLINARY TEAMS: OPTIMIZING CARE IN ADULT AND PEDIATRIC PULMONARY AND CRITICAL CARE	Behavioral, Clinical, Translational	Room 14 A-B (Mezzanine Level): CC
D87	TO EACH ITS OWN: SINGLE CELL MRNA SEQUENCING IN LUNG DEVELOPMENT AND DISEASE	Basic, Translational	Pacific Ballroom 21 (North Tower, First Floor) : MM
D88	PERSONALIZED PREVENTION OF LUNG DISEASE	Basic, Behavioral, Clinical, Translational	Room 3 (Upper Level): CC
D89	LONG-TERM COMPLICATIONS AFTER RESPIRATORY INFECTIONS AND SEPSIS	Clinical, Translational	Grand Ballroom 8-9 (North Tower, Lobby Level): MM
D90	DIVERSITY ACROSS THE CRITICAL CARE SPECTRUM FROM PATIENTS TO CLINICIANS TO LEADERS: WHY IT MATTERS	Clinical, Translational	Grand Ballroom 8-9 (North Tower, Lobby Level): MM
D91	EPITHELIAL PROGENITOR CELLS: BIOLOGY, ROLE IN DISEASE, AND POTENTIAL THERAPEUTIC TARGETS		Grand Ballroom 5-6 (North Tower, Lobby Level): MM

CC: San Diego Convention Center MM: Marriott Marquis San Diego Marina



**ATS 2018**  
Where today's science  
meets tomorrow's care™

San Diego, CA  
May 18 - May 23, 2018  
conference.thoracic.org

## IMPORTANT EVENTS FOR EARLY CAREER PROFESSIONALS

### ATS Journals at the Center for Career Development

**AJRCCM: Monday, May 21 from 12:00 – 1:00 p.m.**

**AJRCMB: Monday, May 21 from 3:00 – 3:45 p.m.**

**AnnalsATS: Tuesday, May 22 from 2:00 – 3:00 p.m.**

This year's AJRCCM, AJRCMB, and AnnalsATS sessions at the Center for Career Development will be on Monday, May 21 and Tuesday, May 22, 2018. These workshops provide attendees the opportunity to receive firsthand advice from our Editors on how to be a successful peer reviewer as well as how to get involved with the ATS Journals family.

### Fellows Case Conference

**Time: 9:15 – 11:15 a.m.**

**Sunday, May 20**

**Location: Ballroom 20 D (Upper Level) - San Diego Convention Center**

The Fellows Case Conference will consist of unique cases presented and discussed by fellows to a panel of clinical experts. Cases will feature clear clinical, radiographic, and pathologic findings and the discussions will yield important teaching for both fellows and seasoned clinicians.

### Amberson Lecture

**Time: 4:30 – 5:45 p.m.**

**Sunday, May 20, 2018**

**Location: San Diego Convention Center, Hall H (Ground Level)**

The Amberson Lecturer is an individual with a career of major lifetime contributions to clinical or basic pulmonary research and/or clinical practice. The Lecture is given in honor of James Burns Amberson, an international authority on chest disease and tuberculosis.

**Lecturer: Scott T. Weiss MD, MS, Boston, MA**

### Recognition Awards for Scientific Accomplishments

**Time: 2:15 – 4:15 p.m.**

**Monday, May 21**

**Location: San Diego Convention Center, Room 32A-B (Upper Level)**

The Recognition Award for Scientific Accomplishments is given to individuals for outstanding scientific contributions in basic or clinical research to the understanding, prevention and treatment of lung disease. Those considered for the award are recognized for either scientific contributions throughout their careers or for major contributions at a particular point in their careers.

**Chairing: A.J. Halayko, PhD, Winnipeg, Canada**

**Awardees: Steven L. Brody, MD, St. Louis, MO  
Jeffrey J. Fredberg, PhD, Boston, MA  
Darrel N. Kotton, MD, Boston, MA  
Bruce D. Levy, MD, Boston, MA**

### Trudeau Medal

**Time: 4:30 - 5:45 p.m.**

**Sunday, May 20**

**Location: San Diego Convention Center, Hall H (Ground Level)**

The Trudeau Medalist is an individual with lifelong major contributions to prevention, diagnosis and treatment of lung disease through leadership in research, education, or clinical care. This award was established in 1926 and is given in honor of Edward Livingston Trudeau, a founder and the first president of the American Lung Association.

**Awardee: Jeffrey A. Whitsett, MD, Cincinnati, OH**

### Distinguished Achievement Award

**Time: 4:30 - 5:45 p.m.**

**Sunday, May 20, 2018**

**Location: San Diego Convention Center, Hall H (Ground Level)**

The Distinguished Achievement Award is given to individuals who have made outstanding contributions to fighting respiratory disease through research, education, patient care, or advocacy.

**Awardees: Qutayba Hamid, MBChB, PhD, Quebec, Canada  
Monica Kraft, MD, Tucson, AZ**

### ATS LGBTQ and Allies Interest Group Reception

**Sunday, May 20, 2018**

**Time: 6:00 - 8:00 p.m.**

**Location: Manchester Grand Hyatt San Diego, Golden Hill AB  
(Third Level- Seaport Tower)**

**Co-Chairs: James M. Beck, MD & Dona J. Upson, MD, MA**

The LGBTQ and Allies Interest Group was formed in 2010 to recognize the LGBTQ community within the ATS. The group meets annually at the ATS International Conference with a social gathering which allows members to network and interact in an informal and open environment. We hope this affords junior members an opportunity for mentorship and advice while facilitating potential collaborations amongst all in the group.

Please RSVP to Vladimir Crevecoeur ([vcrevecoeur@thoracic.org](mailto:vcrevecoeur@thoracic.org)).



## THE ATS AT A GLANCE

### ATS at a Glance

When the members of the MITT Committee first met, we realized there was a lot about the ATS that we didn't know. To make the ATS more accessible, we created the ATS 101 section. We hope this section will give you some ideas on how you can become more active within the organization.

#### How does the ATS work?

The ATS is a member-driven organization, meaning that all decisions are effectively made by members. The day-to-day function of the ATS relies on a dedicated staff of more than 70 employees, who work in offices in New York and Washington, D.C. The Society's leadership is represented by an Executive Committee comprised of the executive director and five elected officers.

Each year, the Society's Nominating Committee selects two candidates from solicited nominations and then the membership votes for who should become the next Secretary-Treasurer. The election results are announced in the ATS News and other Society communications in April.

#### Why should I get involved in the ATS?

As an ATS member, you can have a direct impact on pulmonary, critical care, and sleep medicine both nationally and internationally. Active members help the Society to develop statements and guidelines, create new educational programs, prioritize content for existing activities and guide the political voice of the ATS.

*ATS leaders are actively soliciting the voice of junior members, so the best time to get involved is now!*

#### What are the Assemblies?

As noted early in the Road Map, the 14 ATS Assemblies and three sections are at the heart of the Society's mission. Through these groups, ATS members review, analyze and disseminate the latest basic science, translational, and clinical information. To learn more about Assemblies please go to <http://www.thoracic.org/members/assemblies>.

#### What is an ATS Committee?

Committees are appointed groups that shape and carry out the ATS's many initiatives. The Society's president-elect appoints new committee members in the months preceding each International Conference. To learn more about committees and how to get involved please go to <http://www.thoracic.org/members/committees/index.php>.

#### What is the Public Advisory Roundtable (PAR)?

In February 2001, former ATS president William J. Martin, II, MD, founded ATS PAR, the arm of the ATS that incorporates patient and family perspectives into the Society's activities. Today, ATS PAR comprises 15 member organizations that represent patients affected by respiratory diseases, critical illnesses, and sleep-related conditions. The group collaborates with the ATS to advance their shared educational, research, patient care and advocacy missions. To learn more please go to <http://www.thoracic.org/patients/par/index.php>.

#### How can I be more involved during the International Conference?

International Conference programming, for the most part, is driven by ATS Assemblies. Each Assembly is allotted a specific number of slots for each type of session and its Program Committee ranks various submissions. A direct way to be a part of the conference is to submit your own symposium suggestion to the appropriate assembly during the "Call for Input" period,

which takes place immediately after the conference. To increase the chances of acceptance, ask the assembly program committee chair and/or its members for advice.

Remember, you shouldn't be discouraged by rejection. Assemblies often receive many submissions for only a few symposia slots. Get feedback and try again. Persistence pays off!

#### Where can I access CME?

The ATS is accredited by the Accreditation Council for Continuing Medical Education (ACCME) to provide continuing medical education for physicians.

The designation of AMA PRA Category 1 Credit(s)<sup>™</sup> per session will be available in January and in the Final Program. Physicians should only claim the credit commensurate with the extent of their participation in the activity. This live activity has been planned and implemented in accordance with the essential areas and policies of the ACCME and are free from the control of commercial interests. The ATS is unable to offer AMA PRA Category 1 Credit(s)<sup>™</sup> for sessions that include presentations made by industry-employed speakers if the topic of their presentation relates to a product or business line of their employer. Most of the major symposia, postgraduate courses, workshops and seminars are eligible for AMA PRA Category 1 Credit(s)<sup>™</sup>.

#### How to claim Nursing Contact Hours Credit:

The American Thoracic Society is pleased to announce that it has partnered with National Jewish Health to provide Nursing Contact Hours for selected sessions. After you attend a sessions that has been selected for Nursing Contact Hours, you will complete an evaluation online or at a kiosk by logging in with your registration email and badge number. You will also be asked to provide your nursing license number. Nursing Contact Hour certificate are created upon completion of the evaluation. Certificates may be emailed and /or printed. For more information, go to <http://conference.thoracic.org/program/cme-nursing-ce.php>.

#### Where can I go for more information for Trainees in the field?

The ATS International Conference is one of the largest gatherings for pulmonary, critical care and sleep medicine professionals in the world. For those starting their careers or have recently transitioned into to a career in pulmonary, critical care or sleep, the International Conference is a great opportunity to learn more about the field. To learn more about programs for Trainee please go to <http://www.thoracic.org/members/membership/join-the-ats/special-membership-programs.php>

**If you are interested in getting involved, send an email to: [fellows@thoracic.org](mailto:fellows@thoracic.org).**

#### ATS Staff for Members in Transition and Training

##### Elizabeth Guzman

Manager, Education Projects and Junior Professionals  
Phone: 212-315-8627 • Email: [lguzman@thoracic.org](mailto:lguzman@thoracic.org)

##### Odalys Jimenez

Coordinator, Education Programs  
Phone: 212-315-8683 • Email: [ojimenez@thoracic.org](mailto:ojimenez@thoracic.org)



**ATS 2018**  
*Where today's science  
meets tomorrow's care<sup>™</sup>*

**San Diego, CA**  
**May 18 - May 23, 2018**  
[conference.thoracic.org](http://conference.thoracic.org)



# MENTORING PROGRAMS

A little wisdom can go a long way when it comes to taking the next step in a career path, as well as navigating the International Conference. After sensing this need, the ATS Assemblies have established mentorship programs that pair trainees and early career professionals with more seasoned members. And as an indication of their success, the programs are growing. Program leaders have found that matches have the potential to blossom into lifelong professional relationships.

## MENTORING GOALS

Though variations exist in each program, the goals are universal: support junior faculty and trainees through individualized mentorship, and increase junior faculty and trainee participation in the assembly. The expectation is that the pair will correspond by email and meet in person at least once during the International Conference.

The topics the mentors and mentees cover depends on the experience level of the pair, but leaders find common themes.

## NAVIGATING THE INTERNATIONAL CONFERENCE

Helping mentees broaden their networks is another valuable aspect of the program. Mentees learn the value of the Society and the ins and outs of the International Conference.

*The Assembly Mentoring Programs' Meeting Spot will be located at the Manchester Grand Hyatt in the Balboa A room on the Second Level in the Seaport Tower.*

*The room will be available: Sunday May 20th – Tuesday May 22nd, 2018 from 7 a.m. to 7 p.m.*

For more information about the  
ATS Mentoring Program visit:  
[www.thoracic.org/go/mentoring-program](http://www.thoracic.org/go/mentoring-program)



## ATS MEMBERSHIP MEETINGS

### ATS Assembly Membership Meetings

Assemblies are the heart of the ATS and provide a great entry point to the organization for trainees, junior faculty, and new ATS members. Among other activities, the Society's 14 assemblies are responsible for contributing to the programming and content of the International Conference.

One of the easiest ways to get involved is to attend one or more of the annual Assembly Membership Meetings that you feel best fits your clinical and research interests. Held during the International Conference, these meetings give you the chance to meet the Assembly's leaders in person. If you are interested in becoming involved but find you cannot attend a meeting, you can also contact Assembly leaders by email after the conference.

### Get Involved in ATS Assemblies

Do you often wonder how the ATS and its Assemblies really work? Would you like to get more involved? This is your chance! You can now register here to become more involved in the ATS and its Assemblies. There are many ways to grow within ATS and the Assemblies are a great starting point. Complete the form to get started at: <http://www.thoracic.org/members/assemblies/get-involved-with-ats.php>



#### Sunday, May 20

##### Assembly Membership Meetings

6:30 - 8:30 p.m.

Location: Manchester Grand Hyatt

##### Behavioral Science and Health Services Research (BSHSR)

Chair: Christopher H. Goss, MD, MSc

Incoming Assembly Chair: J. Daryl Thornton, MD, MPH

Website: [thoracic.org/assemblies/bshsr/index.php](http://www.thoracic.org/assemblies/bshsr/index.php)

##### Pediatrics (PEDS)

Chair: Stephanie Davis, MD

Website: [thoracic.org/assemblies/peds/index.php](http://www.thoracic.org/assemblies/peds/index.php)

#### Monday, May 21

##### Assembly Membership Meetings

Time: 5 – 7 p.m.

Location: Manchester Grand Hyatt

##### Allergy, Immunology & Inflammation (AII)

Chair: Bethany Moore, PhD

Website: [thoracic.org/assemblies/aai/index.php](http://www.thoracic.org/assemblies/aai/index.php)

##### Clinical Problems (CP)

Chair: Sanjay Sethi, MD

Website: [thoracic.org/assemblies/cp/index.php](http://www.thoracic.org/assemblies/cp/index.php)

##### Critical Care (CC)

Chair: John Kress, MD

Website: [thoracic.org/assemblies/cc/index.php](http://www.thoracic.org/assemblies/cc/index.php)

##### Environmental, Occupational and Population Health (EOPH)

Chair: Howard M. Kipen, MD, MPH

Incoming Chair: Howard Kipen, MD, MPH

Website: [thoracic.org/assemblies/eoh/index.php](http://www.thoracic.org/assemblies/eoh/index.php)

##### Microbiology, Tuberculosis & Pulmonary Infections (MTPI)

Chair: Kevin P. Fennelly, MD

Incoming Chair: Kristina A. Crothers, MD

Website: [thoracic.org/assemblies/mtpi/index.php](http://www.thoracic.org/assemblies/mtpi/index.php)

##### Nursing (NUR)

Chair: Eileen G. Collins, PhD

Incoming Chair: Kristina A. Crothers, MD

Website: [thoracic.org/assemblies/nur/index.php](http://www.thoracic.org/assemblies/nur/index.php)

##### Pulmonary Circulation (PC)

Chair: Karen Fagen, MD

Website: [thoracic.org/assemblies/pc/index.php](http://www.thoracic.org/assemblies/pc/index.php)

##### Pulmonary Rehabilitation (PR)

Chair: Richard Casaburi, MD

Website: [thoracic.org/assemblies/pr/index.php](http://www.thoracic.org/assemblies/pr/index.php)

##### Respiratory Cell & Molecular Biology (RCMB)

Chair: Irina Petrache, MD

Incoming Assembly Chair: Melanie Koenigshoff, MD, PhD

Website: [thoracic.org/assemblies/rcmb/index.php](http://www.thoracic.org/assemblies/rcmb/index.php)

##### Respiratory Structure & Function (RSF)

Chair: Blanca Camoretti-Mercado, PhD

Incoming Assembly Chair: Gwen S. Skloot, MD

Website: [thoracic.org/assemblies/rsf/index.php](http://www.thoracic.org/assemblies/rsf/index.php)

##### Sleep & Respiratory Neurobiology (SRN)

Chair: Sanjay Patel, MD

Website: [thoracic.org/assemblies/srn/index.php](http://www.thoracic.org/assemblies/srn/index.php)

##### Thoracic Oncology (TO)

Chair: Sanjay Patel, MD

Website: [thoracic.org/members/assemblies/assemblies/thoracic-oncology/](http://www.thoracic.org/members/assemblies/assemblies/thoracic-oncology/)



# JOURNAL OPPORTUNITIES FOR EARLY CAREER PROFESSIONALS

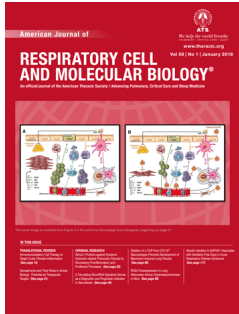

## AJRCMB – Junior Investigator Opportunity

AJRCMB has many new initiatives this year, including the creation of podcast interviews, enhanced social media presence, creation of Red in Motion, the journal's new video series, and creation of Beyond the Red, a section for articles being read by research fellows.

In each issue, at least one paper with a junior investigator as the first or senior author is highlighted by the Editors. One of these junior investigators from a highlighted paper is awarded a plaque and journal notice at the ATS Conference.

Contact Editor-in-Chief Paul Schumacker, PhD, for more details: [p-schumacker@northwestern.edu](mailto:p-schumacker@northwestern.edu)



## AJRCCM – Early Career Group, Images, and Beyond the Blue

The Blue Journal has several opportunities for early career professionals:

- The Early Career Group oversees the Images and Beyond the Blue sections and recommends new enterprises and social media initiatives. They train a network of early career clinicians and researchers in editorial and peer review of manuscripts and image requirements, as well as develop junior associate editors under close supervision.
- The Beyond the Blue section encourages researchers in fellowship programs to provide brief reviews on the most interesting articles recently published in other journals. Each Beyond the Blue article contains 3 short summaries (300-400 words each) written by fellows in the program.

Contact James Allinson, MD, for more details: [j.allinson@imperial.ac.uk](mailto:j.allinson@imperial.ac.uk)

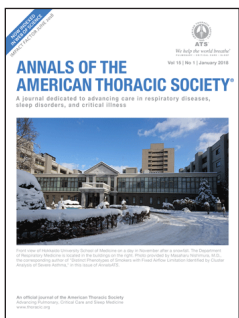

## AnnalsATS—New Editor

We are pleased to announce that Annals of the American Thoracic Society is now indexed in the Web of Science with an impact factor coming in June of 2018! Also of note is that AnnalsATS is now published online and in print.

David Lederer, MD, became the third editor of the journal in 2017. Dr. Lederer's vision for AnnalsATS is for the journal to be a destination for high quality clinical, epidemiological, health services, and medical education research in pulmonary, sleep, and critical care.

We encourage fellows and practicing clinicians to submit to the journal's Case Conferences section. Case Conferences are educational exercises designed to test knowledge and inform clinicians of current approaches to the diagnosis or treatment of specific clinical disorders. These case vignettes are modeled after the case-based teaching conferences incorporated in many fellowship training programs.

Contact Editor-in-Chief David Lederer, MD, for more details: [dl427@cumc.columbia.edu](mailto:dl427@cumc.columbia.edu)

# CENTER FOR CAREER DEVELOPMENT (CCD) SCHEDULE OF EVENTS

7 a.m. – 5 p.m. Sunday, May 20 – Tuesday, May 22, 2018

7 a.m. – 5 p.m. Wednesday, May 23, 2018

San Diego Convention Center | Location: Sails Pavilion (Upper Level)

The Center for Career Development is a professional networking and career development forum for early career professionals (medical students, residents, fellows, post docs, other allied healthcare and research professionals) in training or transitioning from training in Pulmonary, Critical Care or Sleep Medicine. Each day, the CCD features informal workshops aimed at enhancing the professional development for all health care professionals. The sessions in the CCD are a unique and valuable opportunity for YOU to interact with experts in PCCM and have your questions answered about career development topics that are important to you! *Complimentary Breakfast Everyday 7:00 a.m.*

Sunday, May 20, 2018	Monday, May 21, 2018	Tuesday, May 22, 2018
<p>11:00 a.m. – 12:00 p.m.</p> <p><b>How to Get the Most Out of the ATS International Conference</b></p> <p><i>Speakers: Jess Mandel, MD; Patricia A. Kritek, MD</i></p>	<p> 11:00 a.m. – 12:00 p.m.</p> <p><b>What is Health Services Research, &amp; How Do I Become a Health Services Researcher?</b></p> <p><i>Speakers: David Au, MD; Meeta Prasad Kerlin, MD, MS; Deena Kelly Costa PhD, RN</i></p>	<p>11:00 a.m. – 12:00 p.m.</p> <p><b>Defining your Niche—How to Make Yourself Marketable in a Competitive Marketplace</b></p> <p><i>Speakers: Tisha Wang, MD; Amit Gaggar, MD, PhD</i></p>
<p>12:00 – 1:00 p.m.</p> <p><b>Hints &amp; Tips on Leadership in Medicine</b></p> <p><i>Speakers: Sally E. Wenzel, MD; Jesse Roman Rodriguez, MD; David Gozal, MD, MBA</i></p>	<p>12:00 – 1:00 p.m.</p> <p><b>AJRCCM</b></p> <p><b>Early Career Group: How to be a Successful and Effective Peer Reviewer</b></p> <p><i>Jadwiga Wedzicha, MD, PhD; James Allinson, MD</i></p>	<p>12:00 – 1:00 p.m.</p> <p><b>How to Negotiate your First Contract</b></p> <p><i>Speakers: Mark Adelman, MD; Steve Doyle, MD; Michelle Sharp, MD; Morgan Soffler, MD; Gretchen Winter, MD</i></p>
<p>1:00 – 2:00 p.m.</p> <p><b>How to Give Feedback (for fellows &amp;/or early career faculty)</b></p> <p><i>Speakers: Margaret A. Pisani, MD, MPH; Dean Sheppard, MD</i></p>	<p>1:00 – 3:00 p.m.</p> <p><b>BEAR Cage</b></p> <p><i>Hosted by the Drug/Device Discovery and Development Committee (DDDD)</i></p> 	<p>1:00 – 2:00 p.m.</p> <p><b>How to Make the Most of Your Mentor at Different Phases of Your Career</b></p> <p><i>Speakers: Michael W. Sjoding, MD; Carolyn S. Calfee, MD; Sushma Cribbs, MD</i></p>
<p>2:00 – 3:00 p.m.</p> <p><b>What is Translational Research?</b></p> <p><i>Speakers: Ilona Jaspers, PhD; David A. Schwartz, MD; Alison M. Morris, MD, MS; M. Brad Drummond, MD, MHS</i></p>	<p>3:00 – 3:45 p.m.</p> <p><b>AJRCMB</b></p> <p><b>Get Ahead with the Red: Let the Red Journal Help Your Career Development</b></p> <p><i>Paul Schumacker, PhD; Susanne Herold, MD, PhD; Gregory Downey, MD</i></p>	<p>2:00 – 3:00 p.m.</p> <p><b>AnnalsATS</b></p> <p><b>Career Development for Clinical and Epidemiological Researchers: Preparing for your NHLBI K23 Application</b></p> <p><i>David Lederer, MD</i></p>
<p>3:30 – 4:30 p.m.</p> <p><b>How to Get your Medical Education Submissions Published</b></p> <p><i>Speakers: Henry E. Fessler, MD; W. Graham Carlos, MD, MSCR; Jakob McSparron, MD</i></p>	<p>3:45 – 4:30 p.m.</p> <p><b>International Medical Graduates &amp; Careers in Academia</b></p> <p><i>Speakers: Viren Kaul, MD; Pratibha Kaul, MD; Keshia Suhail</i></p>	<p> 3:30 – 4:30 p.m.</p> <p><b>Strategies for Successfully Applying for and Obtaining Grant Funding</b></p> <p><i>Speakers: Rama K. Mallampalli, MD; Jeffrey A. Gold, MD; Rachel Knipe, MD</i></p>
<p>4:30 – 5:30 p.m.</p> <p><b>TEACH Networking Hour</b></p> <p><i>Hosted by the Section on Medical Education</i></p>	<p>4:30 – 5:00 p.m.</p> <p><b>Networking Hour</b></p> <p><i>Hosted by the Pediatric Pulmonary Training Directors Association (PEPTDA)</i></p>	<p>4:30 – 5:00 p.m.</p> <p><b>Networking Hour</b></p> <p><i>Hosted for Physician and Basic Scientists</i></p>
<p><b>Professional Networking from 4:30 – 5:00 p.m.</b></p> <p>Each afternoon, the CCD will host a Networking Hour, with FREE cocktails and appetizers. All medical students, residents, fellows, post docs, other allied healthcare and research professionals are welcome to stop in and network with peers.</p>		



## ATS FACULTY DEVELOPMENT SERIES



Hosted by the Members in Training & Transition Committee (MITT)

7 – 8 a.m.

Location: Room 2 (Upper Level) - San Diego Convention Center

### Seminar 1: Should I Stay or Should I Go? How to Approach the Fellow-To-Faculty & Early Career Faculty Transition

**Date:** Monday, May 21

**Time:** 7:00 - 8:00 a.m.

**Panelists:** Rob Paine, MD (University of Utah);  
Jeremy Richards, MD, MA (Harvard Medical School);  
Yvonne Huang, MD (University of Michigan)

**Moderators:** Jeff Horowitz, MD and Nirmal Sharma, MD  
MITT Committee Members

### Seminar 2: Using Social Media as a Tool, not just a Toy: How to Use Social Media for Career Development and Networking

**Date:** Tuesday, May 22

**Time:** 7:00 - 8:00 a.m.

**Panelists:** Nitin Seam, MD (National Institute of Health); Mel-  
anie Königshoff, MD, PhD (University of Colorado);  
Gregory Martin, MD, MSc (Emory University)

**Moderator:** Megan Ballinger, PhD; MITT Committee Member

### Seminar 3: The Mentor/Mentee Relationship: How to Form an Effective Partnership and Resolve Conflicts

**Date:** Wednesday, May 23

**Time:** 7:00 - 8:00 a.m.

**Panelists:** Timothy S. Blackwell, MD (Vanderbilt University); Beth  
Moore, PhD (University of Michigan); Zea Borok, MD (University  
of Southern California); Irina Petrache, MD (National Jewish Health)

**Moderator:** Gregory Downey, MD; MITT Committee Member

### WHO WILL BENEFIT FROM THESE SESSIONS?

- Clinical & Research Fellows
- Post-Doctoral Fellows
- Residents
- Early Career Professionals
- Anyone interested in gaining practical tools needed to enhance academic success!

**ATTENDANCE IS ON  
A FIRST-COME,  
FIRST-SERVE BASIS.**



## DIVERSITY FORUM / WOMEN'S FORUM

### Diversity Forum

Sunday, May 20, 2018 Time: 11:45 a.m. - 1:15 p.m.

Manchester Grand Hyatt, Grand Hall B

The focus of the Diversity Forum is diversity prevalence among health care professionals today and to address the lack of underrepresented minorities in respiratory medicine. We are pleased to welcome Kristen Bibbins-Domingo, PhD, MD, University of California, San Francisco, as our speaker this year.



MTDS awardees are honored during the Diversity Forum at the ATS International Conference.

In addition, 40 individuals will be recognized and presented with the 2018 Minority Trainee Development Scholarships (MTDS). The MTDS is designed to support travel for trainees of underrepresented minorities to attend the ATS International Conference. Each MTDS recipient is an author of an abstract accepted for presentation at the ATS 2018 International Conference. The awards are based on the quality of science, the contribution of the trainee to the project and the potential impact of the award on the trainee's career development.

### Women's Forum

Monday, May 21, 2018 Time: 11:45 a.m. - 1:15 p.m.

Manchester Grand Hyatt, Grand Hall B

The focus of the annual Women's Forum is to recognize the achievements and support the advancement of women in pulmonary, critical care, and sleep medicine and research. The forum provides a valuable opportunity to meet and network with other women and leaders of the ATS.

This year we are pleased to have Sonia Buist, MD, Oregon Health and Science University (OHSU), as our speaker. She will discuss issues that are relevant to female medical professionals (men are welcome!) followed by a question and answer period. We also hope for vibrant discussion and networking among attendees and the speaker. In addition, the 2018 Elizabeth A. Rich, MD Award will be presented at the forum to a female ATS member who has made significant achievements in the practice or science of a respiratory-related field of medicine, and has demonstrated leadership in her field and dedicated mentorship of her junior colleagues. This year's recipient is Courtney Broaddus, MD, University of California San Francisco.



**Both forums will be hosted by Janet S. Lee, MD, chair of the ATS Membership Committee.**

**Tickets are not required and there is no fee for these programs but advance registration is suggested as space is limited.**



**ATS 2018**  
*Where today's science  
meets tomorrow's care™*

San Diego, CA  
May 18 - May 23, 2018  
[conference.thoracic.org](http://conference.thoracic.org)



The American Thoracic Society is pleased to invite you to:

## BEAR Cage Competition (Building Education to Advance Research)

Monday, May 21, 1–3 p.m.

Center for Career Development

San Diego Convention Center, Sails Pavilion (Upper Level)

Hosted by the ATS Drug Device Discovery and Development (DDDD) Committee, the 4th Annual BEAR Cage (Building Education to Advance Research) competition encouraged early career investigators to submit an innovative clinical or translational research proposal for the opportunity to participate in the live event at ATS 2018. Join us to see the top three finalists competitively “pitch” their proposals to a panel of translational science experts representing academia, industry, and governmental sectors.

Come support and cheer on the finalists as they compete for the \$5,000 grand prize!

All are encouraged and welcome to attend.

# 2018 BEAR Cage Finalists



**Sean Agbor-Enoh, MD, PhD**

National Heart, Lung, and  
Blood Institute (NHLBI)

Precision genomics: early detection of anti-  
body-mediated rejection to improve survival



**Carlos Barrero, MD**

Temple University

Identifying Novel Disease-Modifying Drugs  
for the treatment of Chronic Obstructive  
Pulmonary Disease (COPD)



**Jatinder K. Juss, MD, PhD, FRCPC**

St. Michael's Hospital

NEMESIS (NEutrophil MEchanical StabIlization):  
A novel extracorporeal technology to modu-  
late and monitor pathological inflammatory  
responses of neutrophils (PMN) in acute  
respiratory distress syndrome (ARDS)

The goal of this unique event is to promote productive discussion of these innovative research ideas in the setting of a fun, yet competitive, forum promoting opportunities for collaboration and mentorship.

For more information, please contact [DDDD@thoracic.org](mailto:DDDD@thoracic.org)

# ATS 2018 SCIENCE & INNOVATION CENTER

San Diego Convention Center | Sails Pavilion (Upper Level)

The Science & Innovation Center is a forum for scientists and researchers to meet, network, learn, and rest. The Science & Innovation Center is organized by representatives of the Assembly on Allergy, Immunology and Inflammation (All), Pulmonary Infections and Tuberculosis (PI-TB), Respiratory Cell and Molecular Biology (RCMB), and Respiratory Structure and Function (RSF).

**DAILY:**

- + Complimentary breakfast served at 7 a.m.
- + Light refreshments served at noon
- + Informal networking & rest area all day

Sunday, May 20, 2018	Monday, May 21, 2018	Tuesday, May 22, 2018
<p><b>ATS 101 Series</b> 7:15 - 8:00 a.m.</p> <p><b>Topic:</b> iPSCs</p> <p><b>Speaker:</b> Amy Firth, PhD, University of South California</p>	<p><b>ATS 101 Series</b> 7:15 - 8:00 a.m.</p> <p><b>Topic:</b> Identifying Novel Disease-Modifying Drugs for the treatment of Chronic Obstructive Pulmonary Disease (COPD)</p> <p><b>Speaker:</b> Jeffrey Atkinson, MD, Washington University in St. Louis</p>	<p><b>Early Career Professionals</b> Coffee Corner 7:15 - 8:00 a.m.</p> <p>Meet representatives from Early Career Working groups from All, RCMB, RSF and PI-TB</p>
<p><b>ATS 101 Series</b> 11:15 - 12:00 p.m.</p> <p><b>Topic:</b> Pathogenesis of Pneumonia</p> <p><b>Speaker:</b> Joseph P. Mizgerd, Sc.D., Boston University</p>	<p><b>ATS 101 Series</b> 11:15 - 12:00 p.m.</p> <p><b>Topic:</b> Mitochondria Biology</p> <p><b>Speaker:</b> Navdeep Chandel, PhD, Northwestern University</p>	<p><b>Special Meet and Greet Session with NIH Officials</b> 11:15 - 12:00 p.m.</p> <p><b>Topic:</b> Meet and Greet with NHLBI Program Officers</p> <p><b>Speaker:</b> Matt Craig, PhD Neil Aggarwal, MD, National Institutes of Health</p>
<p><b>Rising Star</b> 1:15 - 3:00 p.m.</p>	<p><b>Rising Star</b> 1:15 - 3:00 p.m.</p>	<p><b>SIC Abstract Awards</b> 1:15 - 3:00 p.m.</p> <p><b>All Abstract winner:</b> 1:20 <b>RCMB Abstract winner:</b> 1:45 <b>PI-TB Abstract winner:</b> 2:10 <b>RSF Abstract winner:</b> 2:35</p>
<p><b>Reception for PhDs &amp; Other Basic Science Researchers</b> Sunday, May 20, 2018 3:30-5:00pm</p>	<p><b>Minority Trainee Development Scholarship (MTDS) Reception</b> Monday, May 21, 2018 3:30-4:30pm</p>	





# GET SOCIAL

The ATS and The Members in Training Committee (MITT) have created social media platforms specifically for early career professionals! These accounts serve to keep you all updated on the latest news in medical education, career development, ATS News), as well as program, and scholarship opportunities relevant to early career professionals.

**Join the #ATS2018 Instagram Contest!**

## CONTEST RULES:

1. Follow **@atscommunity** on Instagram.
2. Post a photo from **#ATS2018** and tell us what you like best about our conference.
3. Use **#ATS2018** in your post.

Three winners will be chosen randomly each day (Friday, May 18 - Wednesday May 23) and will be notified via Instagram DM. Contestants must be attending ATS 2018. Winners photos will be regrammed on the ATS Instagram feed. Pick up your prizes at the ATS office.



**@atsearlycareer**  
"Follow" us on Twitter



**@atsearlycareer**  
"Follow" us on Instagram



**@atsearlycareer**  
"Like us" on Facebook



**ATSCommunity**  
Follow us on Snapchat for a fun and face-to-face way to interact with ATS.

## Hashtags

**#ATS2018**  
General 2018 International Conference

**#ATSEarlyCareer**  
General Early Career Professionals

## GLOBAL HEALTH CAREERS / SIC RECEPTION

# Global Health Careers in Pulmonary & Critical Care Medicine

Sunday, May 20, 2018 | 11:45am - 1:15pm  
International Participants Center  
Sails Pavilion (Upper Level) San Diego Convention Center

### Session Summary:

This interactive session will provide early career professionals an invaluable opportunity to interface and network with pulmonary & critical care faculty with established global health careers and researchers from LMICs. Panelists will include both junior and senior faculty from high income countries and low and middle income countries and will highlight different pathways to establishing partnerships and building an academic career in global health.

### Chairs:

- 1) Juliana Ferreira (University of Sao Paulo, Sao Paulo, Brazil)
- 2) Neill Adhikari (Sunnybrook Health Sciences Centre, University of Toronto, Canada)

# Reception for PhDs & Other Basic Science Researchers

Science and Innovations Center  
Sunday, May 20, 2018, 3:30 - 5 p.m.  
San Diego Convention Center Sails Pavilion (Upper Level)

The ATS Science and Innovations Center (SIC) working group, organized by Megan Ballinger, PhD and the PhD working group, would like to invite PhDs and other Basic Science Researchers to a special reception event in the SIC. The reception will provides an intimate setting for networking while also allowing guests to mingle. Cocktails and appetizers will be provided.

**For questions, please contact Lauren Krampen at [lkrampen@thoracic.org](mailto:lkrampen@thoracic.org) or Liz Guzman at [lguzman@thoracic.org](mailto:lguzman@thoracic.org).**

- This event is FREE to conference registrants
- Registration is encouraged
- Attendance is first-come, first-serve



# *Did you know?*



- First time domestic and international trainee members are eligible to join the ATS for free for one year. For more information, scan QR code to right.
- The ATS has designed a website to help early career professionals on their path to successful careers in pulmonary, critical care, and sleep medicine. For more information, scan QR code to right.



Contact [fellows@thoracic.org](mailto:fellows@thoracic.org) for more information.



*We help the world breathe*<sup>®</sup>  
PULMONARY • CRITICAL CARE • SLEEP

# SAN DIEGO CONVENTION CENTER

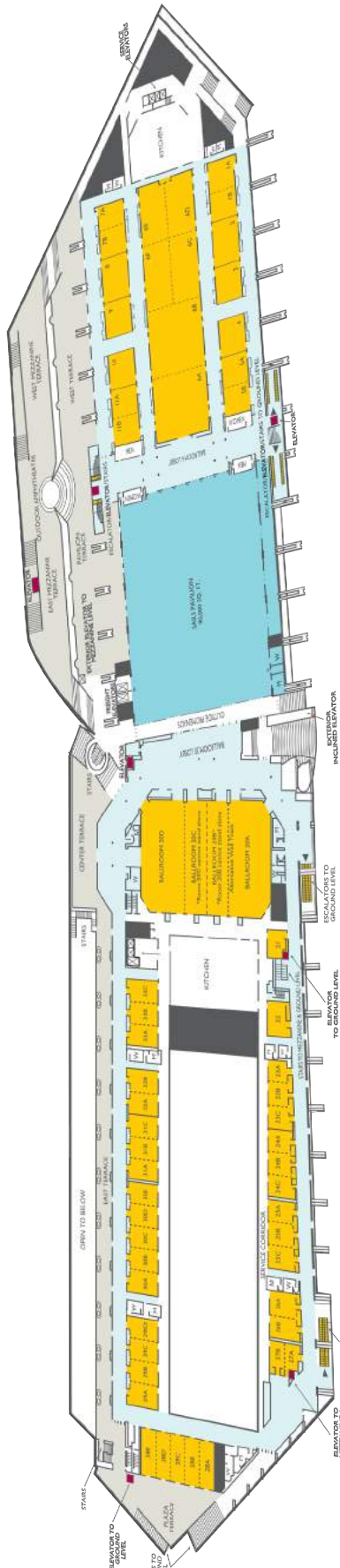

**UPPER LEVEL**

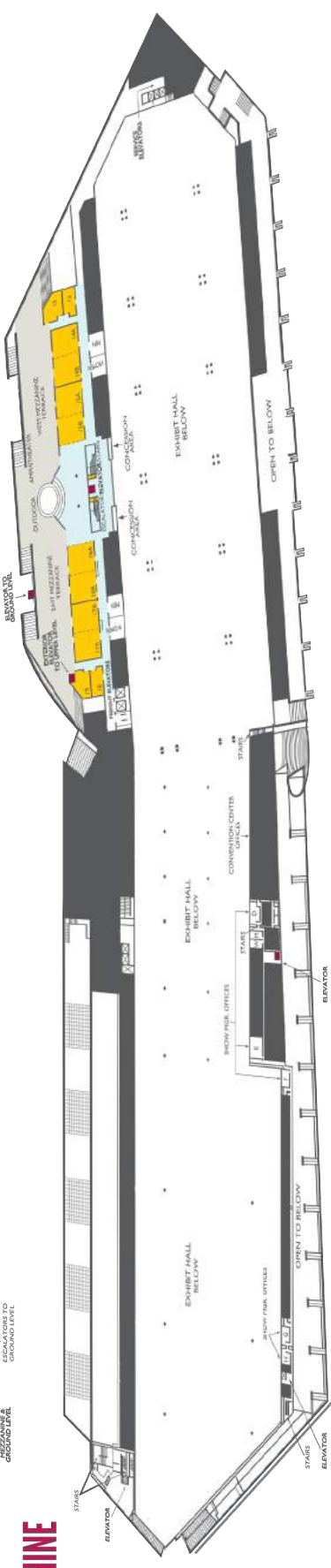

**MEZZANINE LEVEL**

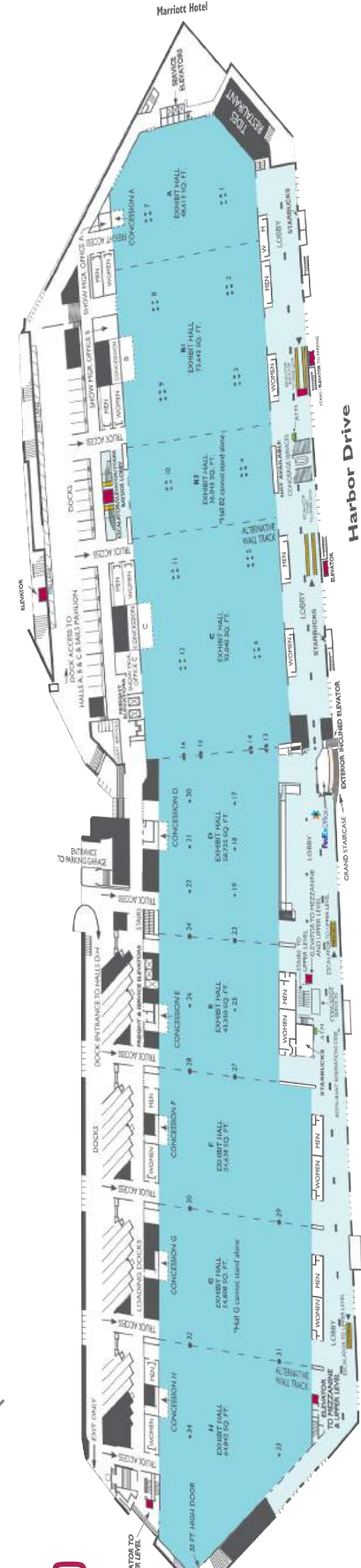

**GROUND LEVEL**

*The ATS Would Like to Acknowledge  
its 2018 Corporate Members*



BENEFACTOR



PATRON



SUPPORTER



FRIEND



*Thank you for your support.*



We help the world breathe®  
PULMONARY • CRITICAL CARE • SLEEP

CORPORATE MEMBERSHIP PROGRAM

For more information, please visit [www.thoracic.org](http://www.thoracic.org)



FOURTEENTH ANNUAL

# Respiratory Disease Young Investigators' Forum

A Research Mentorship and Advancement  
Opportunity for Pediatric, Pulmonary,  
Allergy and Immunology Fellows  
and Early Career Physician Scientists

OCTOBER 11-14, 2018

THE DARCY

WASHINGTON, DC

## Why Apply To Attend?

- Opportunity to present your research
- Receive feedback to effectively enhance research presentations
- Career strategies and development sessions
- Networking with peers and renowned expert faculty
- Travel, lodging, and meal expenses covered

## How It Works

Submit an abstract on your research (clinical or basic science), abstracts are blinded and scored by expert faculty. The top 30 abstracts are accepted and invited to attend the Forum as faculty to present their research in full. Based on scores of the expert faculty, **the top 3 presenters in each category will receive a monetary award.**

## For More Information

[njhealth.org/YIF2018](http://njhealth.org/YIF2018) or call 303.728.6585

## 2017 Attendee Comment

**"This is my new favorite conference.** As a young investigator, I frequently feel like a bystander at large conferences. It was refreshing and immensely educational to participate in a conference focused on my stage of training and composed of my peers."

**Abstract Submission Deadline  
June 18, 2018**

