

American Thoracic Society International Conference



*Where today's science meets tomorrow's care™*

# 2017 ROAD MAP

## for Early Career Professionals



**ATS 2017**

*Where today's science  
meets tomorrow's care™*

May 19 - May 24, 2017  
Washington, DC  
[conference.thoracic.org](http://conference.thoracic.org)

## WELCOME

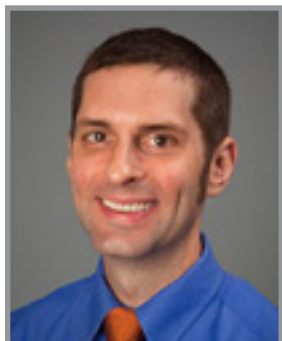

Jeremy Richards, MD, MA  
Chair, MITT Committee

Welcome to ATS 2017 in Washington, D.C.! With more than 15,000 attendees from more than 100 countries, ATS 2017 is one of the largest gatherings of pulmonary, critical care, and sleep medicine professionals in the world. The Members In Transition and Training (MITT) Committee understand that the ATS conference can be daunting to navigate, which is why we created the Road Map for Early Career Professionals.

The Road Map is a flowsheet of all the major events at ATS 2017. You will see that members of the MITT Committee have highlighted activities of particular interest to residents, fellows, and early career professionals. In addition to using the Road Map to navigate major sessions, you should search the entire ATS conference program for research symposia and poster sessions related to your specific interests, and we highly encourage you to attend these sessions.

In the Road Map, we have also highlighted several events, programs, resources and tools that are of particular interest to residents, fellows, and early career professionals:

- **Center for Career Development (CCD):** You should stop by the Center for Career Development! The CCD is a networking forum where senior clinicians and researchers offer advice on different aspects of career development for clinicians, clinician educators, researchers, and more. Check out the schedule for the CCD and come to the sessions that seem most interesting to you!
- **ATS 101:** In the Road Map, we offer a brief written overview of how the ATS is structured as an organization, and highlight opportunities to get involved. In addition, there will be a live session in the Center for Career Development on Sunday, May 21st from 11AM-12PM to review tips and strategies to help you navigate the conference.
- **Assembly Business Meetings:** We strongly believe that the Assembly business meetings are the best way to get involved in the ATS. More information about the ATS Assemblies can be found on page 10.
- **Adult and Pediatric Core Curriculum Sessions:** ATS 2017 features a core curriculum that showcases adult and pediatric medicine that corresponds with online modules submitted to the ABIM and ABP for MOC. For updates on ATS 2017 offerings, please go to <https://cms.psav.com/ats2017/confcal>
- **Grant Resource Guide:** A comprehensive list of funding sources specific for fellows and early career faculty will be available in the Center for Career Development. The Grant Resource Guide is also online: <https://www.thoracic.org/professionals/career-development/fellows/grant-resource-guide.php>

There are many ways to get involved with in the ATS. In addition to participating in the Assemblies, there are many committees, task forces, and opportunities to advocate for improved health care for patients and increased funding for research. If you are interested in getting more involved, please contact ATS staff members Elizabeth Guzman and Odalys Jimenez, who work closely with the MITT Committee at [fellows@thoracic.org](mailto:fellows@thoracic.org).

Again, welcome to ATS 2017! We hope you have an exciting and informative experience.

Sincerely,

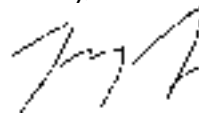
A handwritten signature in black ink, appearing to read 'JR'.

Jeremy Richards, MD, MA  
Chair, MITT Committee

# CONTENTS

Welcome Letter .....	inside front cover
Networking Exchange for Early Career Professionals.....	2
Roadmap Schedule.....	3
Important Events for Early Career Professionals.....	7
ATS 101 .....	8
ATS Assembly Membership Meetings.....	10
Journal Opportunities for Early Career Professionals .....	11
Center for Career Development .....	12
Special Events in the CCD .....	13
FREE Workshops for Early Career Professionals .....	14
Diversity Forum & Women’s Forum.....	15
BEAR Cage.....	16
Science & Innovation Center .....	17
Get Social .....	18
Did you know?.....	19



## THE NETWORKING EXCHANGE FOR EARLY CAREER PROFESSIONALS

Become an  
ATS member  
for FREE!

Connect  
with  
Peers!

Get  
involved!

Learn more  
about  
the ATS  
conference!

COME MINGLE WITH COLLEAGUES, MENTORS AND PEERS  
COMPLIMENTARY DRINKS AND APPETIZERS

**Saturday, May 20, 2017**  
**5:30-6:30 P.M.**

**Marriott Marquis Washington**  
**University of DC/Catholic University (Level M1)**

The event is FREE to paid conference registrant.  
Sponsored by The Membership and Training Committee (MITT)

Questions? Contact Liz Guzman ([lguzman@thoracic.org](mailto:lguzman@thoracic.org)) or Odalys Jimenez ([ojimenez@thoracic.org](mailto:ojimenez@thoracic.org))

**Connect with Us! Use #ATSEarlyCareer**



**ATS 2017**  
*Where today's science  
meets tomorrow's care™*

**Washington, DC**  
**May 19-May 24**  
[conference.thoracic.org](http://conference.thoracic.org)

# Road Map Daily Schedule

**Sunday, May 21**

Highlighted sessions are recommended by MITT for early career professionals.

## Morning Sessions

Session Code	Title	Assembly Recommendations	Room
Early Morning Session Time: 7:00 - 8:00 a.m.			
PCC1	Pediatric Clinical Core Curriculum		Ballroom B (South Building, Level 3), CC
Morning Session Time: 9:15 - 11:15 a.m.			
A1	Clinical Year in Review 1		Hall E (Middle Building, Level 2), CC
A3	Fellows Case Conference		Ballroom C (South Building, Level 3), CC
A4	Determinants of Long-Term Outcomes Among Critically Ill Older Adults: From Cell to Population		Room 146 A-B (Middle Building, Street Level), CC
A5	Dohad: Developmental Origins of Health and Disease and the Circle of Life for Lung Disease		Independence Ballroom E-H (Level M4), MM
A6	Barbarians at the Gate: Viruses and the Airway Epithelium in Asthma		Ballroom A (South Building, Level 3), CC
A7	Hot Topics in Pulmonary Rehabilitation: A Pro/Con Debate		Room 143 A-C (Middle Building, Street Level), CC
A8	A Pro-Con Debate: Controversies in PAH Pathogenesis	PC	Liberty Ballroom I-L (Level M4), MM
A9	In Memory of Peter T. Macklem: Emergent Phenomena and Heterogeneity in Respiratory Disease	RSF	Marquis Ballroom 5 (Level M2), MM
A10	A Pro/Con Debate in Pediatric Asthma	PED	Ballroom B (South Building, Level 3), CC
A11	Lung Cancer Screening and Tobacco Cessation: The Teachable Moment?	TO	Independence Ballroom A (Level M4), MM
A12	The Promise and Reality of Wearable Health Technology	BSHSR	Room 152 A-B (Middle Building, Street Level), CC
Afternoon Session Time: 11:45 a.m. - 1:15 p.m.			
CC1	Critical Care Clinical Core Curriculum I		Hall E (Middle Building, Level 2), CC

## Lunch Sessions

Session Code	Title	Assembly Recommendations	Room
Lunch Session Times 12:15 - 1:15 p.m.			
L1	American Lung Association Airways Clinical Research Centers Clinical Trials		Room 143 A-C (Middle Building, Street Level), CC
L2	Air Pollution and Public Health		Room 202 A (South Building, Level 2), CC
L3	Work-Related Lung Disease: Still With Us		Room 202 B (South Building, Level 2), CC
L4	Pulmonary Update from the U.S. Food and Drug Administration		Room 204 A-C (South Building, Level 2), CC
L5	Research Funding Opportunities		Room 102 A-B (South Building, Street Level), CC
L6	Phenotyping in the Subpopulations and Intermediate Outcome Measures in COPD (Spiromics) Study		Room 145 A-B (Middle Building, Street Level), CC
L7	Asthmanet Clinical Trial Results		Room 147 A-B (Middle Building, Street Level), CC
L8	Lung Disease Projects in Trans-Omics for Precision Medicine (Topmed) Program	PC	Room 152 A-B (Middle Building, Street Level), CC
L9	Mapping Lung Health and Disease with the Molecular Atlas of Lung Development	RSF	Room 146 C (Middle Building, Street Level), CC

## Afternoon Sessions

Session Code	Title	Assembly Recommendations	Room
Afternoon Session Times: 2:15p.m. - 4:15p.m.			
A81	Nursing Year in Review	NUR	Room 102 A-B (South Building, Street Level), CC
A82	Idiopathic Pulmonary Fibrosis: Controversies in Management - Pro/Con Debate	CP	Ballroom A (South Building, Level 3), CC
A83	Great Cases	CP	Ballroom C (South Building, Level 3), CC
A85	The Exosome Concept: Understanding Impact on Lung Health And Disease	RSF	Independence Ballroom E-H (Level M4), MM
A86	The Sleep State of the Union: Taking OSA Management to Washington	SRN	Room 152 A-B (Middle Building, Street Level), CC
A87	ATS Mythbusters: One OME to Rule Them All: We Will Find a Common Prime Mover For Pulmonary Fibrosis	RCMB	Marquis Ballroom 5 (Level M2), MM
A88	Sex, Sugar, Salt and Stress: Neurohormonal Signaling as a Novel Therapeutic Target in Right Ventricular Failure		Liberty Ballroom I-L (Level M4), MM
A89	Smoldering TB: Exploring the Full Spectrum of Infection With MTB	MTPI, All	East Salon A-C (South Building, Street Level), CC
A90	Making New Links: Mechanisms of Organ Failure in Sepsis and ARDS	RCMB	Room 146 A-B (Middle Building, Street Level), CC
A91	Catching Fire: The Global Health Issue of Household Air Pollution	EOPH	Room 145 A-B (Middle Building, Street Level), CC
A92	It's Not Dorothy Andersen's CF Anymore		Ballroom B (South Building, Level 3), CC

CC = Walter E. Washington Convention Center MM = Marriott Marquis Washington



# Road Map Daily Schedule

## Monday, May 22

Highlighted sessions are recommended by MITT for early career professionals.

### Morning Sessions

Session Code	Title	Assembly Recommendations	Room
Early Morning Session Time: 7:00 - 8:00 a.m.			
PCC2	Pediatric Clinical Core Curriculum		Ballroom B (South Building, Level 3), CC
Morning Session Time: 9:15 - 11:15 a.m.			
B1	Clinical Year in Review 2		Hall E (Middle Building, Level 2), CC
B2	The Long-Term Oxygen Treatment Trial (LOTT): Implications for COPD Patient Care	SRN, BSHSR	Ballroom A (South Building, Level 3), CC
B3	The Cancer Moonshot: ATS = Mission Control for Lung Cancer	RCMB, TO	Marquis Ballroom 6 (Level M2), MM
B4	Humanizing the Intensive Care Unit: New Perspectives on an Old Problem	CC	Room 146 A-B (Middle Building, Street Level), CC
B5	Smokers with Preserved Spirometry: Early COPD?	RSF	Independence Ballroom E-H (Level M4), CC
B6	Mechanical Ventilation in the NICU, PICU and at Home: What the Pediatric Pulmonologist Should Know	PED	Ballroom C (South Building, Level 3), CC
B7	From Research to Bedside: Optimizing Well-Being Through Integrative Therapy	NUR, BSHSR	Room 102 A-B (South Building, Street Level), CC
B8	Realizing the Paris Climate Agreement to Improve Cardio-Pulmonary Health: Where Science Meets Policy	BSHSR, EOPH	Room 147 A-B (Middle Building, Street Level), CC
B9	Gaming the System or Saving Lives: Pay for Performance in the 21st Century		Room 204 A-C (South Building, Level 2), CC
B10	Sepsis Goes to Washington: Regulations, Definitions, and Research Shaping the Future of Sepsis	CC, RCMB	Room 145 A-B (Middle Building, Street Level), CC
B11	The Lung Endothelium Pro/Con Session: The Key Culprit in Chronic Lung Disease	RCMB	Marquis Ballroom 5 (Level M2), MM
B12	The Importance of Technology Implementation in Respiratory Care and Public Health		Room 202 B (South Building, Level 2), CC
B13	A Potpourri of Epigenetics in Respiratory Disease		Room 202 A (South Building, Level 2), CC
Mid-Afternoon Session Times: 11:45 a.m. - 1:15 p.m.			
CC2	Pulmonary: Venothromboembolic Disease, Pleural Disease, Smoking Cessation		Hall E (Middle Building, Level 2), CC

### Lunch Sessions

Session Code	Title	Assembly Recommendations	Room
Lunch Session Times: 12:15 - 1:15 p.m.			
L11	Update From CDC's TB Trials Consortium and the TB Epi Studies Consortium		Room 143 A-C (Middle Building, Street Level), CC
L12	How do Respiratory Microbes Contribute to Asthma?		Room 207 A-B (South Building, Level 2), CC
L13	Environmental Influences on Children's Pulmonary Health	BSHSR	Room 202 A (South Building, Level 2), CC
L14	Generic Drug Development for Respiratory Products: U.S. Food and Drug Administration Update		Room 204 A-C (South Building, Level 2), CC
L15	VA Career Development Awards: How They Can Launch Academic Careers	SRN	Room 102 A-B (South Building, Street Level), CC
L16	New Results from the Copdgene Study		Room 145 A-B (Middle Building, Street Level), CC
L17	Prevention and Early Treatment of Acute Lung Injury Clinical Trial Network (NHLBI Petal)		Room 147 A-B (Middle Building, Street Level), CC
L18	New Insights about Severe Asthma from the NHLBI Severe Asthma Research Program		Room 152 A-B (Middle Building, Street Level), CC
L19	NHLBI Pvdomics Program: Deep Phenotyping of Pulmonary Vascular Diseases in Patients		Room 146 C (Middle Building, Street Level), CC
L20	The Occupational Safety and Health Administration's Rule on Respirable Crystalline Silica		Room 202 B (South Building, Level 2), CC

### Afternoon Sessions

Session Code	Title	Assembly Recommendations	Room
Afternoon Session Times: 2:15 - 4:15 p.m.			
CC3	Critical Care Clinical Core Curriculum II		Hall E (Middle Building, Level 2), CC
B81	Pediatric Year in Review	PED	Ballroom B (South Building, Level 3), CC
B82	Hot Topics in COPD: A Pro Con Debate	CP	Ballroom A (South Building, Level 3), CC
B83	A Multidisciplinary, Case-Based Approach to Hot Topics in CTD-ILD	PED, CP	Ballroom C (South Building, Level 3), CC
B84	Chronic, Persistent, Prolonged, and Just Plain Stuck: Insights in Chronic Critical Illness		Room 146 A-B (Middle Building, Street Level), CC
B85	Environment and Lung Aging: An Ecological Model	RCMB	Independence Ballroom E-H (Level M4), MM
B86	"Signed, Sealed, Delivered": Extracellular Vesicles as Messengers, Biomarkers, and Therapeutic Vehicles		Marquis Ballroom 5 (Level M2), MM
B87	Reprogramming of Lung Tumor Microenvironment: A Path to Cancer Core for Better Therapeutic Benefit		Independence Ballroom A (Level M4), MM
B88	The Gene-Environment Interaction in Interstitial Lung Disease	EOPH	Room 143 A-C (Middle Building, Street Level), CC
B89	Immunocompromised Host Pneumonia: Expanding Risks and Novel Management Strategies	MTPI, All	West Salon G-I (South Building, Street Level), CC
B90	Discussion and Debate in the Management of Pulmonary Embolism	PC, CP	Liberty Ballroom I-L (Level M4), MM
B91	Implementation Science in Pulmonary, Critical Care, Sleep and Pediatric Medicine: How Soon is Now?	SRN, BSHSR	East Salon A-C (South Building, Street Level), CC
B92	100 Years of AJRCCM 1917-2017		Room 202 A (South Building, Level 2), CC

# Road Map Daily Schedule

Tuesday, May 23

Highlighted sessions are recommended by MITT for early career professionals.

## Morning Sessions

Session Code	Title	Assembly Recommendations	Room
Early Morning Session Time: 7:00 - 8:00 a.m.			
PCC3	Pediatric Clinical Core Curriculum		Ballroom B (South Building, Level 3), CC
Morning Session Time: 9:15 - 11:15 a.m.			
C1	Clinical Year in Review 3	MTPI	Hall E (Middle Building, Level 2), CC
C2	Practice Changing Clinical Trials in Pleural Diseases: Impact on Day-to-Day Care		Ballroom A (South Building, Level 3), CC
C3	Obesity and Lung Disease		Ballroom C (South Building, Level 3), CC
C4	A Stitch in Time: Controversies in Critical Care Best Practices and Their Effect on Patient Centered Outcomes	CC	Room 146 A-B (Middle Building, Street Level), CC
C5	Early Life Environmental Programming of Chronic Lung Disease		Independence Ballroom E-H (Level M4), MM
C6	Reducing Readmissions for COPD: Strategies, Issues and Results		Room 146 C (Middle Building, Street Level), CC
C7	Evolution and Impact of the Microbiome in Pediatric Inflammatory Airway Diseases		Ballroom B (South Building, Level 3), CC
C8	Precision Medicine in Pulmonary Vascular Diseases: Are We Ready for the Future?	PC	Liberty Ballroom I-L (Level M4), MM
C9	Mitochondria Biogenesis and Dysfunction in Pulmonary Diseases	RCMB	Marquis Ballroom 5 (Level M2), MM
C10	Positive Pressure + Negative Adherence = High Priority Future Research Need	SRN	Room 152 A-B (Middle Building, Street Level), CC
C11	Pollution Effects on the Epigenome in the Development of Chronic Lung Disease	All	Room 147 A-B (Middle Building, Street Level), CC
C12	Physician Payment in the United States: Past, Present and Future or What is MACRA (Medicare Access and Chip Reauthorization Act of 2015)		Room 102 A-B (South Building, Street Level), CC
Mid-Afternoon Session Times: 11:45 a.m. - 1:15 p.m.			
CC4	Sleep Medicine Clinical Core Curriculum I		Hall E (Middle Building, Level 2), CC

## Afternoon Sessions

Session Code	Title	Assembly Recommendations	Room
Afternoon Session Times: 2:15 - 4:15 p.m.			
CC5	Pulmonary Clinical Core Curriculum II		Hall E (Middle Building, Level 2), CC
C82	The Cutting Edge in Lung Transplantation	CP	Ballroom A (South Building, Level 3), CC
C83	Pediatric Chest Rounds		Ballroom C (South Building, Level 3), CC
C84	Beg, Borrow and Steal: The Challenge of Changing Physician Behavior in the ICU		Room 146 A-B (Middle Building, Street Level), CC
C85	Regulation of the Stress Response in Lung Disease	RCMB	Independence Ballroom E-H (Level M4), MM
C86	Clinical Advances in Respiratory Health: What to Tell Your Patients Right Now	SRN	Room 204 A-C (South Building, Level 2), CC
C87	Dawn of the Dead (Cell): Necroptosis in the Pathogenesis of Lung Diseases	All	Marquis Ballroom 5 (Level M2), MM
C88	Copd Comorbidities: Greater Than the Sum of the Parts		Room 102 A-B (South Building, Street Level), CC
C89	Non-Cystic Fibrosis Bronchiectasis and Nontuberculous Mycobacteria Infection: Current Knowledge and Recent Advances	MTPI, All	West Salon G-I (South Building, Street Level), CC
C90	Pulmonary Rehabilitation Across Health Care Settings		Liberty Ballroom M-P (Level M4), MM
C91	Tackling Severe Pneumonia and Sepsis: What is Ready for Prime Time?	MTPI	East Salon A-C (South Building, Street Level), CC
C92	State of the Art on Thoracic Imaging and Radiographic Metrics in the Quantification of Lung Disease		Marquis Ballroom 6 (Level M2), MM

CC = Walter E. Washington Convention Center

MM = Marriott Marquis Washington

# Road Map Daily Schedule

## Wednesday, May 24

Highlighted sessions are recommended by MITT for early career professionals.

### Morning Sessions

Session Code	Title	Assembly Recommendations	Room
Early Morning Session Time: 7:00- 8:00 a.m.			
PCC4	Pulmonary Hypertension, Rheumatologic Disease		
Morning Session Time: 9:15 - 11:15 a.m.			
D1	Clinical Year in Review 4	TO	Hall E (Middle Building, Level 2), CC
D2	Bronchoscopic Lung Volume Reduction: Is it Finally a Reality?		Ballroom A (South Building, Level 3), CC
D3	Diagnostic Dilemmas in Hypersensitivity Pneumonia and the Clinical-Radiologic-Pathologic Multidisciplinary Standard		Ballroom C (South Building, Level 3), CC
D4	Balancing Personalization and Protocol in the ICU	CC	Room 146 A-B (Middle Building, Street Level), CC
D5	Preventing Asthma Onset in Children by Immunomodulation Using Bacteria or Bacterial Extracts		Ballroom B (South Building, Level 3), CC
D6	Sleep and Health: A Public Health Call to Action	SRN	Room 152 A-B (Middle Building, Street Level), CC
D7	Air Pollution and Psychosocial Stress and the Origins of Lung Disease	BSHSR, EOPH	Room 147 A-B (Middle Building, Street Level), CC
D8	The Next Next-Generation: Function, Modeling and Mechanism and the Lung Microbiome	MTPI, RCMB	Independence Ballroom A (Level M4), MM
D9	Navigating Our Brave New World: Stem Cells, Ethics, and Public Policy	BSHSR, RCMB	Marquis Ballroom 5 (Level M2), MM
D10	Environmental Pollution and the Global Rise in COPD Footprint	EOPH	Room 145 A-B (Middle Building, Street Level), CC

### Lunch Sessions

Session Code	Title	Assembly Recommendations	Room
Lunch Session Times: 12:15 - 1:15 p.m.			
L21	Towards a FDA Comprehensive Nicotine Regulatory Policy: How Do Electronic Nicotine Delivery Systems Fit?		Room 204 A-C (South Building, Level 2), CC
L22	NASA's Satellites and their Use in Studying Health and Air Quality: Highlight from the NASA Health and Air Quality Applied Sciences Team		Room 102 A-B (South Building, Street Level), CC
L23	Promoting Access to Guidelines-Based Care for People With Asthma		Room 143 A-C (Middle Building, Street Level), CC
L24	Patient-Centered Outcome Research Institute (PCORI): PCORNET and Evidence to Action Networks Update		Room 202 B (South Building, Level 2), CC
L25	The Pulmonary Trials Cooperative (PTC): Purpose, Structure and Current Trials		Room 145 A-B (Middle Building, Street Level), CC
L26	NHLBI-Funded Resources for Improving Long-Term Outcomes Clinical Research for Acute Respiratory Failure		Room 147 A-B (Middle Building, Street Level), CC
L27	Federal Resources to Translate Research from Lab to Patients		Room 146 C (Middle Building, Street Level), CC
L28	Building Knowledge with Design from the Environmental Influences on Child Health Outcomes (ECHO)		Room 152 A-B (Middle Building, Street Level), CC
L29	Black Lung and Uranium Workers Programs		Room 202 A (South Building, Level 2), CC

### Afternoon Sessions

Session Code	Title	Assembly Recommendations	Room
Afternoon Session Times: 1:30 - 3:30 p.m.			
CC6	Sleep Medicine Clinical Core Curriculum II		Independence Ballroom E-H (Level M4), MM
D82	Putting the 2017 Gold COPD Recommendations into Clinical Practice		Ballroom A (South Building, Level 3), CC
D83	Innovative Clinical Trials in Pulmonary Fibrosis and Beyond		Ballroom C (South Building, Level 3), CC
D84	50 Years of ARDS: Looking Back, and Ahead	CC	Room 146 A-B (Middle Building, Street Level), CC
D85	Recognition, Diagnosis and Management of Indolent Lung Cancer	TO	Room 202 A (South Building, Level 2), CC
D86	Interactions Between Fat and Flow	SRN	Marquis Ballroom 5 (Level M2), MM
D87	Obesity and Chronic Respiratory Diseases in Children: Recent Advances and Clinical Implications		Ballroom B (South Building, Level 3), CC
D88	Life in the Fast Lane: Use of Pluripotent Stem Cells in Pulmonary Disease	PC, RCMB	Liberty Ballroom I-L (Level M4), MM
D89	Of Mice and Men: Mechanisms of Granulomatous Inflammation	MTPI, All	Marquis Ballroom 6 (Level M2), MM
D90	Nudges in the ICU: When and How Should Intensivists Guide Surrogates' Decisions?	NUR	Room 152 A-B (Middle Building, Street Level), CC
D91	ATS Clinical Practice Guidelines: Clinical Practice on the Cutting Edge		Room 204 A-C (South Building, Level 2), CC



# IMPORTANT EVENTS FOR EARLY CAREER PROFESSIONALS

## Early Career Group

---

**Monday, May 22, 2017**

**Time: Noon – 1:00 p.m.**

**Location: Walter E. Washington Convention Center, Hall D (Middle Building, Level 2)**

The Editors of the Red Journal annually select the best manuscript for which the first or senior author qualifies as a Junior Investigator (graduate student, fellow, post doc, or Assistant Professor). This Junior Investigator is presented with an award acknowledging their accomplishments at the RCMB Assembly at the ATS International Conference.

## Fellows Case Conference

---

**Sunday, May 21, 2017**

**Time: 9:15 – 11:15 a.m.**

**Location: Ballroom C (South Building, Level 3), Walter E. Washington Convention Center**

The Fellows Case Conference will consist of unique cases presented and discussed by fellows to a panel of clinical experts. Cases will feature clear clinical, radiographic, and pathologic findings and the discussions will yield important teaching for both fellows and seasoned clinicians.

## Amberson Lecture

---

**Sunday, May 21, 2017**

**Time: 4:30 – 5:45 p.m.**

**Location: Hall E, Level 2, Walter E. Washington Convention Center**

The Amberson Lecturer is an individual with a career of major lifetime contributions to clinical or basic pulmonary research and/or clinical practice. The Lecture is given in honor of James Burns Amberson, an international authority on chest disease and tuberculosis.

Lecturer: Peter D. Pare, MD, Vancouver, Canada

## Recognition Awards for Scientific Accomplishments

---

**Monday, May 22, 2017**

**Time: 2:15 – 4:15 p.m.**

**Location: Room 204 A-C (South Building, Level 2), Walter E. Washington Convention Center**

The Recognition Award for Scientific Accomplishments is given to individuals for outstanding scientific contributions in basic or clinical research to the understanding, prevention and treatment of lung disease. Those considered for the award are recognized for either scientific contributions throughout their careers or for major contributions at a particular point in their careers.

Chairing: A.J. Halayko, PhD, Winnipeg, Canada

Awardees:

John V. Fahy, MD, MSc, San Francisco, CA

Andrew Fontenot, MD, Boulder, CO

Alison Morris, MD, MS, Pittsburgh, PA

Andrew M. Tager, MD, Boston, MA

## ATS LGBTQ and Allies Interest Group Reception

---

**Sunday, May 21, 2017**

**Time: 6:00 – 8:00 p.m.**

**Location: Renaissance Washington, Meeting Room 13-14 (Meeting Room Level)**

**Co-Chairs: James M. Beck, MD & Dona J. Upson, MD, MA**

The LGBTQ and Allies Interest Group was formed in 2010 to recognize the LGBTQ community within the ATS. The group meets annually at the ATS International Conference with a social gathering which allows members to network and interact in an informal and open environment. We hope this affords junior members an opportunity for mentorship and advice while facilitating potential collaborations amongst all in the group.

Please RSVP to Vladimir Crevecoeur ([vcrevecoeur@thoracic.org](mailto:vcrevecoeur@thoracic.org)).

## ATS 101

When the members of the MITT Committee first met, we realized there was a lot about the ATS that we didn't know. To make the ATS more accessible, we created the ATS 101 section. We hope this section will give you some ideas on how you can become more active within the organization.

### How does the ATS work?

The ATS is a member-driven organization, meaning that all decisions are effectively made by members. The day-to-day function of the ATS relies on a dedicated staff of more than 70 employees, who work in offices in New York and Washington, D.C. The Society's leadership is represented by an Executive Committee comprised of the executive director and five elected officers.

Each year, the Society's Nominating Committee selects two candidates from solicited nominations and then the membership votes for who should become the next Secretary-Treasurer. The election results are announced in the ATS News and other Society communications in April.

### Why should I get involved in the ATS?

As an ATS member, you can have a direct impact on pulmonary, critical care, and sleep medicine both nationally and internationally. Active members help the Society to develop statements and guidelines, create new educational programs, prioritize content for existing activities and guide the political voice of the ATS.

**ATS leaders are actively soliciting the voice of junior members, so the best time to get involved is now!**

### What are the Assemblies?

As noted early in the Road Map, the 14 ATS Assemblies and three sections are at the heart of the Society's mission. Through these groups, ATS members review, analyze and disseminate the latest basic science, translational, and clinical information. To learn more about Assemblies please go to <http://www.thoracic.org/members/assemblies/>.

### What is an ATS Committee?

Committees are appointed groups that shape and carry out the ATS's many initiatives. The Society's president-elect appoints new committee members in the months preceding each International Conference. To learn more about committees and how to get involved please go to <http://www.thoracic.org/members/committees/index.php>.

### What is the Public Advisory Roundtable (PAR)?

In February 2001, former ATS president William J. Martin, II, MD, founded ATS PAR, the arm of the ATS that incorporates patient and family perspectives into the Society's activities. Today, ATS PAR comprises 15 member organizations that represent patients affected by respiratory diseases, critical illnesses, and sleep-related conditions. The group collaborates with the ATS to advance their shared educational, research, patient care and advocacy missions. To learn more please go to <http://www.thoracic.org/patients/par/index.php>.

### How can I be more involved during the International Conference?

International Conference programming, for the most part, is driven by ATS Assemblies. Each Assembly is allotted a specific number of slots for each type of session and its Program Committee ranks various submissions. A direct way to be a part of the conference is to submit your own symposium suggestion to the appropriate assembly during the "Call for Input" period, which takes place immediately after the conference. To increase the chances of acceptance, ask the assembly program committee chair and/or its members for advice.

Remember, you shouldn't be discouraged by rejection. Assemblies often receive many submissions for only a few symposia slots. Get feedback and try again. Persistence pays off!

### Where can I access CME?

The ATS is accredited by the Accreditation Council for Continuing Medical Education (ACCME) to provide continuing medical education for physicians.

The designation of AMA PRA Category 1 Credit(s)<sup>TM</sup> per session will be available in January and in the Final Program. Physicians should only claim the credit commensurate with the extent of their participation in the activity. This live activity has been planned and implemented in accordance with the essential areas and policies of the ACCME and are free from the control of commercial interests. The ATS is unable to offer AMA PRA Category 1 Credit(s)<sup>TM</sup> for sessions that include presentations made by industry-employed speakers if the topic of their presentation relates to a product or business line of their employer. Most of the major symposia, postgraduate courses, workshops and seminars are eligible for AMA PRA Category 1 Credit(s)<sup>TM</sup>.

**How to claim Nursing Contact Hours Credit:**

The American Thoracic Society is pleased to announce that it has partnered with National Jewish Health to provide Nursing Contact Hours for selected sessions. After you attend a sessions that has been selected for Nursing Contact Hours, you will complete an evaluation online or at a kiosk by logging in with your registration email and badge number. You will also be asked to provide your nursing license number. Nursing Contact Hour certificate are created upon completion of the evaluation. Certificates may be emailed and /or printed. For more information, go to <http://conference.thoracic.org/program/cme-nursing-ce.php>.

**Where can I go for more information for Trainees in the field?**

The ATS International Conference is one of the largest gatherings for pulmonary, critical care and sleep medicine professionals in the world. For those starting their careers or have recently transitioned into to a career in pulmonary, critical care or sleep, the International Conference is a great opportunity to learn more about the field. To learn more about programs for Trainee please go to <http://www.thoracic.org/members/membership/join-the-ats/special-membership-programs.php>

If you are interested in getting involved, send an email to [fellows@thoracic.org](mailto:fellows@thoracic.org).

**ATS Staff for Members in Transition and Training**

Elizabeth Guzman  
Manager, Education Projects and Junior Professionals  
Phone: 212-315-8627  
Email: [lguzman@thoracic.org](mailto:lguzman@thoracic.org)

Odalys Jimenez  
Coordinator, Education Programs  
Phone: 212-315-8683  
Email: [ojimenez@thoracic.org](mailto:ojimenez@thoracic.org)

# ATS MEMBERSHIP MEETINGS

## ATS Assembly Membership Meetings

Assemblies are the heart of the ATS and provide a great entry point to the organization for trainees, junior faculty, and new ATS members. Among other activities, the Society's 14 assemblies are responsible for contributing to the programming and content of the International Conference.

One of the easiest ways to get involved is to attend one or more of the annual Assembly Membership Meetings that you feel best fits your clinical and research interests. Held during the International Conference, these meetings give you the chance to meet the Assembly's leaders in person. If you are interested in becoming involved but find you cannot attend a meeting, you can also contact Assembly leaders by email after the conference.

### Assembly Orientation

The Assemblies hold a brief orientation meeting that takes place 30 minutes before the Assembly Membership Meeting. At the orientation meeting you will have the opportunity to meet the Assembly's leaders, learn about the Assembly's structure and way to participate and get involved. All members welcomed and are encouraged to attend.

### Sunday Assembly Membership Meetings

6:30 p.m.–8:30 p.m.

#### Behavioral Science and Health Services Research (BSHSR)

Chair: Christopher H. Goss, MD, MSc

Website: [thoracic.org/assemblies/bshsr/index.php](http://thoracic.org/assemblies/bshsr/index.php)

#### Pediatrics (PEDI)

Chair: James F. Chmiel, MD, MPH

Incoming Chair: Stephanie Davis, MD

Website: [thoracic.org/assemblies/peds/index.php](http://thoracic.org/assemblies/peds/index.php)

### Monday Assembly Membership Meetings

Time: 5:00 p.m.–7:00 p.m.

#### Allergy, Immunology & Inflammation (All)

Chair: Mitchell A. Olman, MA, MD

Incoming Chair: Bethany Moore, PhD

Website: [thoracic.org/assemblies/aii/index.php](http://thoracic.org/assemblies/aii/index.php)

#### Clinical Problems (CP)

Chair: Sanjay Sethi, MD

Website: [thoracic.org/assemblies/cp/index.php](http://thoracic.org/assemblies/cp/index.php)

#### Critical Care (CC)

Chair: Carolyn S. Calfee, MD, MAS

Incoming Chair: John Kress, MD

Website: [thoracic.org/assemblies/cc/index.php](http://thoracic.org/assemblies/cc/index.php)

#### Environmental, Occupational and Population Health (EOPH)

Chair: Jack R. Harkema, DVM, PhD, DACVP

Incoming Chair: Howard Kippen, MD, MPH

Website: [thoracic.org/assemblies/eoh/index.php](http://thoracic.org/assemblies/eoh/index.php)

#### Microbiology, Tuberculosis & Pulmonary Infections (MTPI)

Chair: Kevin P. Fennelly, MD

Website: [thoracic.org/assemblies/mtpi/index.php](http://thoracic.org/assemblies/mtpi/index.php)

#### Nursing (NUR)

Chair: Eileen G. Collins, PhD

Website: [thoracic.org/assemblies/nur/index.php](http://thoracic.org/assemblies/nur/index.php)

#### Pulmonary Circulation (PC)

Chair: Troy Stevens, PhD

Incoming Chair: Karen Fagan, MD

Website: [thoracic.org/assemblies/pc/index.php](http://thoracic.org/assemblies/pc/index.php)

#### Pulmonary Rehabilitation (PR)

Chair: Carolyn L. Rochester, MD

Incoming Chair: Richard Casaburi, MD, PhD

Website: [thoracic.org/assemblies/pr/index.php](http://thoracic.org/assemblies/pr/index.php)

#### Respiratory Cell & Molecular Biology (RCMB)

Chair: Irina Petrache, MD

Website: [thoracic.org/assemblies/rcmb/index.php](http://thoracic.org/assemblies/rcmb/index.php)

#### Respiratory Structure & Function (RSF)

Chair: Blanca Camoretti-Mercado, PhD

Website: [thoracic.org/assemblies/rsf/index.php](http://thoracic.org/assemblies/rsf/index.php)

#### Sleep & Respiratory Neurobiology (SRN)

Chair: Susheel P. Patil, MD, PhD

Incoming Chair: Sanjay Patel, MD

Website: [thoracic.org/assemblies/srn/index.php](http://thoracic.org/assemblies/srn/index.php)

#### Thoracic Oncology (TO)

Chair: Michael K. Gould, MD, MS

Incoming Chair: M. Patricia Rivera, MD

Website: [thoracic.org/members/assemblies/assemblies/thoracic-oncology/](http://thoracic.org/members/assemblies/assemblies/thoracic-oncology/)

## Assembly Mentorship Program

ATS Assembly Mentoring Programs offer valuable advice and wisdom at critical points in a member's career development. Designed to foster formal facilitated mentoring connections to help mentees grow and advance their careers, the programs provide support through individualized attention.

### Meet Your Mentor

Struggling to find a quiet location to meet with your mentor? Look no further! This year at the 2017 ATS International Conference in Washington, DC, the Assembly Mentoring Programs is offering a meeting spot exclusively for mentors and mentees to meet.

The Assembly Mentoring Programs' Meeting Spot will be located at the Renaissance Hotel in the Carnegie room on the Ballroom Level of the Hotel. The room will be available: **Sunday May 21st – Tuesday May 23rd, 2017 from 7 a.m. to 7 p.m.**

Light snacks and beverages will be offered throughout the day. Also in the room there will be laptops and printers available for use. You can also pick up your Assembly Mentoring Program ribbon and pin!

Find out more about  
ATS Assemblies here



## JOURNAL OPPORTUNITIES FOR EARLY CAREER PROFESSIONALS



## AJRCMB – Junior Investigator Opportunity

In each issue, at least one paper with a junior investigator as the first or senior author is highlighted by the editors; at the ATS Conference, one of these junior investigators from a highlighted paper is awarded a plaque and journal notice.

Contact Editor-in-Chief Paul Schumacker, PhD,  
for more details: [p-schumacker@northwestern.edu](mailto:p-schumacker@northwestern.edu)



## AJRCCM – Early Career Group, Images, and Beyond the Blue

The Blue Journal has several opportunities for early career professionals:

- The Early Career Group oversees the Image and Beyond the Blue sections, and recommends new enterprises and social media initiatives. They have developed a network of 25 early career clinicians and researchers who are being trained in peer review of manuscripts and editorial review of Image submissions. Members of the network are also trained as junior associate editors under close supervision.
- The Images section seeks content related to pulmonary, critical care, or sleep medicine for which the images are the main content. Authors are also encouraged to submit relevant videos, and these images and/or videos should be accompanied by 200 words or fewer describing the content and techniques.
- The Beyond the Blue section allows researchers in a fellowship program to provide brief reviews on the most interesting articles recently published in other journals. Each Beyond the Blue article contains 3 short summaries (300-400 words each) written by a fellow in the program.

For information on any of these Blue Journal opportunities, please contact Alex Mackay, PhD:  
[alexander.mackay@ucl.ac.uk](mailto:alexander.mackay@ucl.ac.uk)

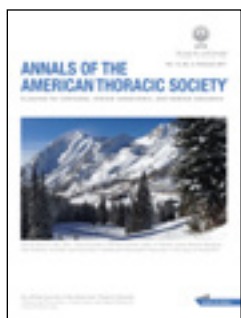

## AnnalsATS—New Editor

Please welcome David Lederer, MD, our new Editor. Dr. Lederer has exciting plans to create new initiatives for young professionals—stay tuned for more!



**ATS 2017**  
*Where today's science  
meets tomorrow's care™*

Washington, DC  
May 19-May 24  
[conference.thoracic.org](http://conference.thoracic.org)

# CENTER FOR CAREER DEVELOPMENT

SUNDAY, MAY 21 – TUESDAY, MAY 23, 2017

7:00 a.m. – 5:00 p.m.

## WALTER E. WASHINGTON CONVENTION CENTER HALL D (MIDDLE BUILDING, LEVEL 2)

The Center for Career Development is a professional networking and career development forum for early career professionals (medical students, residents, fellows, post docs, other allied health care and research professionals) in training or transitioning from training. Each day, the CCD features informal workshops aimed at enhancing the professional development for all health care professionals. The workshops in the CCD are a unique and valuable opportunity for YOU to interact with experts the field.

**Complimentary breakfast every day 7:00 a.m.**

### SUNDAY, MAY 21, 2017

**Time: 11:00 a.m. – Noon**

**Topic: ATS 101**

Speakers: Monica Kraft, MD, University of Arizona Health Sciences Center; Trish Kritek, MD, EdM, University of Washington

**Time: Noon – 1:00 p.m.**

**Topic: How to Write a Paper**

Speakers: Gisli Jenkins, MD, Thorax; Martin Kolb, MD, PhD, McMaster University; Toby Maher, MD, Imperial College of London; Ellen Burnham, MD, University of Colorado Denver

**Time: 2:00 – 4:00 p.m.**

**BEAR Cage**

The top three submissions chosen by the ATS Drug Device Discovery and Development (DDDD) Committee will be invited to pitch their highly innovative research proposals to a panel of translational science experts representing academia, industry, and governmental sectors in front of a live audience during the ATS 2017 International Conference

**Time: 4:00 – 5:00 p.m.**

**Topic: How to Create a Podcast and Web-Based Videos for Medical Education**

Speaker: Rosemary Adamson, MBBS, University of Washington; Garth Garrison, MD, University of Vermont; Nitin Seam, MD, National Institute of Health

**Time: 5:00 – 6:00 p.m. TEACH - Medical Education Fellow Mixer**

### MONDAY, MAY 22, 2017

**Time: 11:00 a.m. – Noon**

**Topic: How to Get Involved in Government and Advocacy**

Speakers: Dean Schraufnagel, MD, University of Illinois at Chicago; Douglas Arenberg, MD, University of Michigan; Gary Ewart, Chief, Advocacy & Government Relations, American Thoracic Society

**Time: Noon – 1:00 p.m.**

**Topic: Early Career Group: How to be a Successful and Effective Peer Reviewer**

Speaker: Dr. Jadwiga Wedzicha, MD, PhD; National Heart and Lung Institute Airways Disease; Alexander MacKay, PhD, The Royal London Hospital Barts Health NHS Trust

**Time: 1:00 – 2:00 p.m.**

**Topic: How to Write a Specific Aims Page**

Speakers: Michael Matthay, MD, University of California San Francisco; Beth Moore, MD, University of Michigan; Fernando Holguin, MD, University of Colorado

**Time: 3:00 – 4:00 p.m.**

**Topic: Get Ahead with the Red: Let the Red Journal Help Your Career Development**

Speakers: Paul Schumacker, PhD, Northwestern University; Susanne Herold, PhD, University of Giessen Lung Center; Gregory Downey, MD, National Jewish Health

**Time: 4:00 – 5:00 p.m.**

**Topic: Best Practices in Billing and Coding for Senior PCCM Fellows**

Speakers: Kevin Kovitz, MD, The Chicago Chest Center; Katina Nicolacakis, MD, Cleveland Clinic

### TUESDAY, MAY 23, 2017

**Time: 11:00 a.m. – Noon**

**Topic: How to Teach Effectively at the Bedside**

Speakers: Gregory Schmidt, MD, University of Iowa; JP Kress, MD, University of Chicago; Daryl Thornton, MD, MPH, MetroHealth Medical Center; Teresa Hammond, MD, Keck School of Medicine of USC

**Time: Noon – 1:00 p.m.**

**Global Health Session – LMIC Practice and Opportunities**

Speakers: Cecilia Patino-Sutton (University of Southern California); Juliana Ferreira (Universidade de Sao Paulo); William Checkley (Johns Hopkins); Gonzalo Gianella (Universidad Peruana Cayetano Heredia)

**Time: 1:00 – 2:00 p.m.**

**Topic: How to Access ATS Grants**

Speakers: Jesse Roman, MD, University of Louisville; Scott Budinger, MD, Northwestern University; Richard Schwab, MD, University of Pennsylvania

**Time: 4:00 – 5:00 p.m.**

**Topic: How to Develop an Effective Training Plan**

Speakers: Monica Kraft, MD, University of Arizona; Jeffrey Horowitz, MD, University of Michigan; David Schwartz, MD, University of Colorado

### Professional Networking Hour from 3:30 – 4:30 p.m.

Each afternoon, the CCD will host a Networking Hour, which will include FREE cocktails and appetizers. All medical students, residents, fellows, post docs, other allied healthcare and research professionals are welcome to stop in and network with peers.



## SPECIAL EVENTS IN THE CCD

# The ATS MITT Committee Invites You To Attend Special Events in the CCD!

## The Trainee Educators ATS Camaraderie Hour (TEACH)

TEACH is a networking hour intended to provide fellows and junior faculty opportunities to meet like-minded clinician educators to foster relationships and collaborations.

**Sunday, May 21, 2017**

**5:00 - 6:00 p.m.**

**Walter E. Washington Convention Center**

**Location: Center for Career Development**

**Hall D (Middle Building, Level 2)**

\*This networking hour is organized by members of the ATS Section on Medical Education.

### CHAIRS AND PANELISTS

**Michelle Sharp MD**

*Johns Hopkins University*

**Lekshmi Santhosh MD**

*University of California at San Francisco*

**Anna Brady MD**

*University of Washington*

**Stephanie Maximous MD**

*University of Pittsburgh Medical Center*

**Briana Short MD**

*Columbia University Medical Center*

## How to Get Involved in Government & Advocacy

This session will give you helpful tips and information on how you can become more active in government.

**Monday, May 22, 2017**

**11:00 a.m. - Noon**

**Walter E. Washington Convention Center**

**Location: Center for Career Development**

**Hall D (Middle Building, Level 2)**

### CHAIRS AND PANELISTS

**Dean Schraufnagel, MD**

*University of Illinois at Chicago*

**Douglas Arenberg, MD**

*University of Michigan*

**Gary Ewart**

*Chief, Advocacy & Government Relations  
ATS*

These Events Are Free To Paid Conference Registrants

Questions? Contact

Liz Guzman (lguzman@thoracic.org)

Odalys Jimenez (ojimenez@thoracic.org)

**#ATSEarlyCareer**

**FREE WORKSHOP SESSIONS FOR EARLY CAREER PROFESSIONALS****Marriott Marquis Washington, Capital/Congress (Level M4)****WS2 Sunday, May 21, 11:45 a.m. - 1:15 p.m.****Global Health Careers in Pulmonary and Critical Care Medicine**

This intimate session will provide early career professionals an invaluable opportunity to interface and network with pulmonary and critical care faculty with established global health careers. Panelists will include both junior and senior faculty and will highlight different pathways to achieving success, including academic/research, private practice, non-governmental organization (NGO), faith-based medical education, and hybrid models.

**WS4 Monday, May 22, 11:45 a.m. - 1:15 p.m.****Career Advancement for Clinician Educators: Fostering Leadership, Scholarship and Opportunities for Success**

During this interactive session, participants will have the opportunity to hear from successful, nationally recognized clinician educators in pulmonary and critical care medicine regarding career pathways in the field. The focus will be on career development and job attainment.

**WS6 Tuesday, May 23, 11:45 a.m. - 1:15 p.m.****Career Development Workshop: How to Start Your Independent Research Laboratory**

To sustain productivity during this initial period, appropriate plans are needed in the processes including negotiating the job terms, staffing the laboratory, and managing the time and personnel. The participants will hear from six members of the ATS community comprising of senior investigators and recently hired investigators each from educational institutions and industrial organizations or research laboratories.

**WS8 Wednesday, May 24, 11:45 a.m. - 1:15 p.m.****Preparing for Entering the Grant Shark Tank: Attaining Early Career Funding**

This session will provide attendees with a cutting edge review of novel diagnostic technologies that can be used to facilitate rapid and accurate identification and characterization of the etiology of acute pneumonia

**For more information, visit: <http://conference.thoracic.org/program/session-information/>**

These sessions are free to conference attendees but registration is required.

## DIVERSITY FORUM / WOMEN'S FORUM

### Diversity Forum

Sunday, May 21, 2017 11:45 a.m. – 1:15 p.m.

Renaissance Washington Downtown, Grand Ballroom North

The focus of the Diversity Forum is diversity prevalence among health care professionals today and to address the lack of underrepresented minorities in respiratory medicine. We are pleased to welcome Eliseo J. Pérez-Stable, M.D., Director, National Institute on Minority Health and Health Disparities at the National Institutes of Health, as our speaker this year.



MTDS awardees are honored during the Diversity Forum at the ATS International Conference.

In addition, 40 individuals will be recognized and presented with the 2017 Minority Trainee Development Scholarships (MTDS). The MTDS is designed to support travel for trainees of underrepresented minorities to attend the ATS International Conference. Each MTDS recipient is an author of an abstract accepted for presentation at the ATS 2017 International Conference. The awards are based on the quality of science, the contribution of the trainee to the project and the potential impact of the award on the trainee's career development.

### Women's Forum

Monday, May 22, 2017 11:45 a.m. – 1:15 p.m.

Renaissance Washington Downtown, Grand Ballroom North

The focus of the annual Women's Forum is to recognize the achievements and support the advancement of women in pulmonary, critical care, and sleep medicine and research. The forum provides a valuable opportunity to meet and network with other women and leaders of the ATS.

This year we are pleased to have Redonda Miller, MD, MBA, of The Johns Hopkins Hospital, as our speaker. In 2016 Dr. Miller became the first woman to hold the position in the hospital's 127-year history. She will discuss issues that are relevant to female medical professionals (men are welcome!) followed by a question and answer period. We also hope for vibrant discussion and networking among attendees and the speaker. In addition, the 2017 Elizabeth A. Rich, MD Award will be presented at the forum to a female ATS member who has made significant achievements in the practice or science of a respiratory-related field of medicine, and has demonstrated leadership in her field and dedicated mentorship of her junior colleagues. This year's recipient is Zea Borok, MD, University of Southern California.



**Both forums will be hosted by Yolanda Mageto, MD, chair of the ATS Membership Committee.**

**Tickets are not required and there is no fee for these programs but advance registration is suggested as space is limited.**

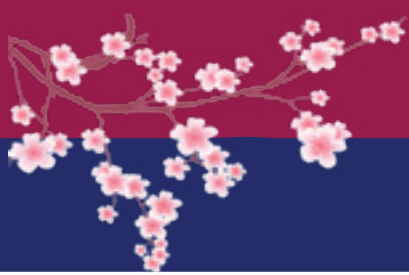

The American Thoracic Society is pleased to invite you to:

**BEAR Cage**  
**(Building Education to Advance Research)**

Sunday, May 21, 2017 2:00-4:00 p.m.

Center for Career Development

Walter E. Washington Convention Center, Hall D, (Middle Building, Level 2)

Hosted by the ATS Drug Device Discovery and Development (DDDD) Committee, the 3rd Annual BEAR Cage (Building Education to Advance Research) competition encouraged early career investigators to submit an innovative clinical or translational research proposal for the opportunity to participate in the live event at ATS 2017. Join us to see the top three finalists competitively “pitch” their proposals to a panel of translational science experts representing academia, industry, and governmental sectors.

Come support and cheer on the finalists as they compete for the \$5,000 grand prize!  
All are encouraged and welcome to attend.

---

## 2017 BEAR Cage Finalists



**Marcus Y. Chen, MD**

National Heart, Lung, and Blood Institute (NHLBI)  
*Chest CT at Chest X-ray Radiation Dose*

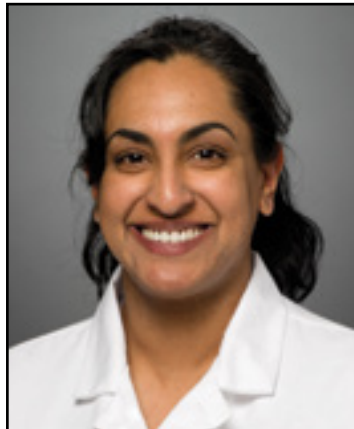

**Prema R. Menon, MD, PhD**

University of Vermont Medical Center  
*Communicating with Mechanically Ventilated Patients*



**Sanghyuk Shin, PhD**

UCLA Fielding School of Public Health  
*Unmasking Resistance: Impact of Low-frequency Drug-Resistance on Molecular Diagnosis of Drug-Resistant Tuberculosis*

---

The goal of this unique event is to promote productive discussion of these innovative research ideas in the setting of a fun, yet competitive, forum promoting opportunities for collaboration and mentorship.

For more information, please contact [DDDD@thoracic.org](mailto:DDDD@thoracic.org)

## SCIENCE &amp; INNOVATION CENTER

SUNDAY, MAY 21, THROUGH TUESDAY, MAY 23: 7:00 a.m. – 5:00 p.m.

WEDNESDAY, MAY 24: 7:00 a.m. – 1:00 p.m.

WALTER E. WASHINGTON CONVENTION CENTER,  
HALL D (MIDDLE BUILDING, LEVEL 2)

The Science & Innovation Center is a forum for scientists and researchers to meet, network, learn, and rest. The Science & Innovation Center is organized by representatives of the All, MTPI, RCMB, and RSF Assemblies.

## DAILY

- Breakfast served at 7:00 a.m.
- Light refreshments served at noon
- Informal networking & rest area all day

## SIC 101

Interested in a scientific symposium, but need to brush up on the basics before venturing out to the cutting edge? Stop by for the SIC 101 series, where you can learn the basic principles underpinning high profile symposia at ATS 2017 Washington, DC.

## Sunday, May 21

7:15 – 8:00 a.m.

**Genomics**

Blanca Himes, PhD  
*University of Pennsylvania*

11:15 a.m. – Noon

**E. Cigarettes and Effects  
of Lung Immunology**

Laura Alexander-Crotty, MD  
*University of California San Diego*

## Monday, May 22

7:15 – 8:00 a.m.

**EX Vivo 3D Lung Tissues 101**

Melanie Königshoff, MD, PhD  
*University of Colorado, Denver*

11:15 a.m. – Noon

**RNA Seq / Single Cell  
RNA Seq**

Max Seibold, PhD  
*National Jewish Health*

## SPECIAL EVENTS

## Sunday, May 21, and Monday, May 22

1:15 – 3:00 p.m.

**Rising Stars of Research**

Join the All, MTPI, RCMB, and RSF assemblies in celebrating their Rising Stars. Rising Stars are basic and translational science researchers at the assistant professor or early associate professor level making waves in their fields. Each Rising Star will give a 15 minute presentation on their work with time for Q&A at the end of the session.

## Tuesday, May 23

7:15 – 8:00 a.m.

**Early Career Professionals Coffee Corner**

Mentors and mentees are welcome to talk, collaborate, and caffeinate.

11:15 a.m. – Noon

**Complementing NIH Funding: Philanthropic Organizations**

Katherine L. Tuggle, Ph.D.

Learn how to seek funding from a wider range of sources. Meet a representative from the Cystic Fibrosis Foundation.

1:15 – 3:00 p.m.

**SIC Abstract Awards**

Join us to celebrate the best scientific abstracts submitted to ATS 2017 Washington, DC by early career professionals.



# GET SOCIAL

The ATS and The Members in Training Committee (MITT) have created social media platforms specifically for early career professionals! These accounts serve to keep you all up-to-date on the latest news in medical education, career development, ATS News), as well as program, scholarship and opportunities relevant information for early career professionals.

## WHAT'S NEW?

We are really excited to announce we will be Live Tweeting at the 2017 International Conference. We encourage you to use the hashtags below to participate in the conversation from your seats at presentations!



**@atsearlycareer**  
"Follow" us on Twitter



**@atsearlycareer**  
"Follow" us on Instagram



**@atsearlycareer**  
"Like us" on Facebook



**ATSCommunity**  
Follow us on Snapchat for a fun and face-to-face way to interact with ATS.

## Hashtags

**#ATS2017**

General 2017 International Conference

**#ATSEarlyCareer**

General Early Career Professionals





# *Did you know?*



- First time domestic and international trainee members are eligible to join the ATS for free for one year. For more information, go to <http://www.thoracic.org/members/membership/join-the-ats/special-membership-programs.php>
- The ATS has designed a website to help early career professionals on their path to successful careers in pulmonary, critical care, and sleep medicine. For more information, go to <http://www.thoracic.org/professionals/career-development/>

Contact [fellows@thoracic.org](mailto:fellows@thoracic.org) for more information.



*We help the world breathe®*  
PULMONARY • CRITICAL CARE • SLEEP

# WALTER E. WASHINGTON CONVENTION CENTER

## LOWER LEVEL

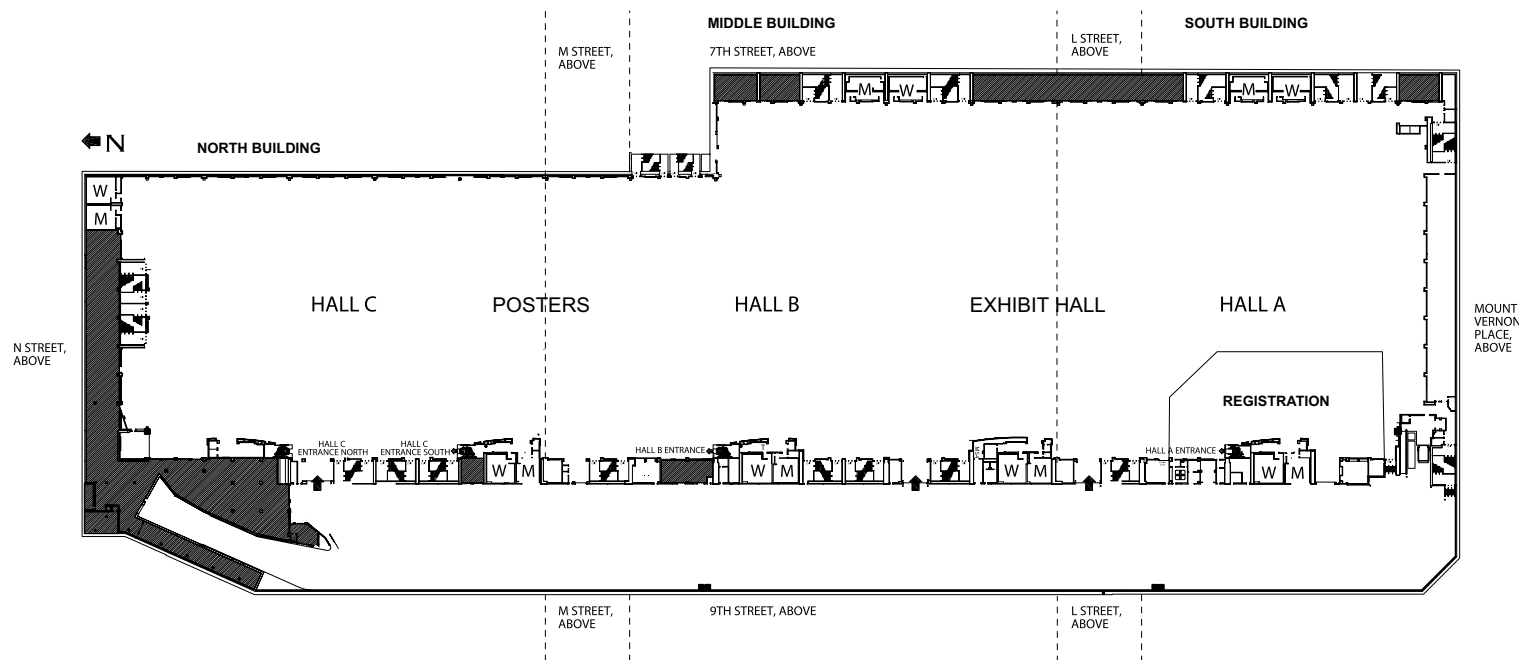

## CONCOURSE LEVEL

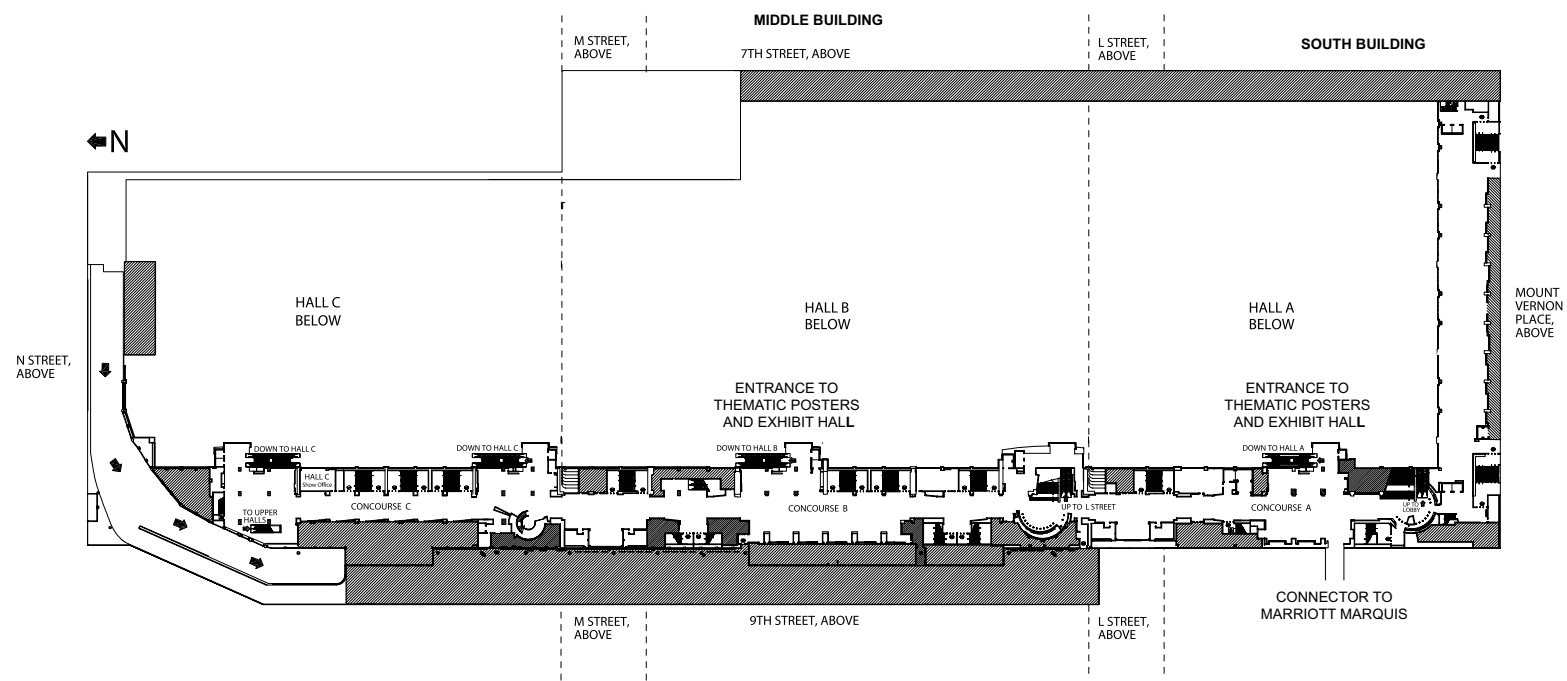

# WALTER E. WASHINGTON CONVENTION CENTER

## STREET LEVEL

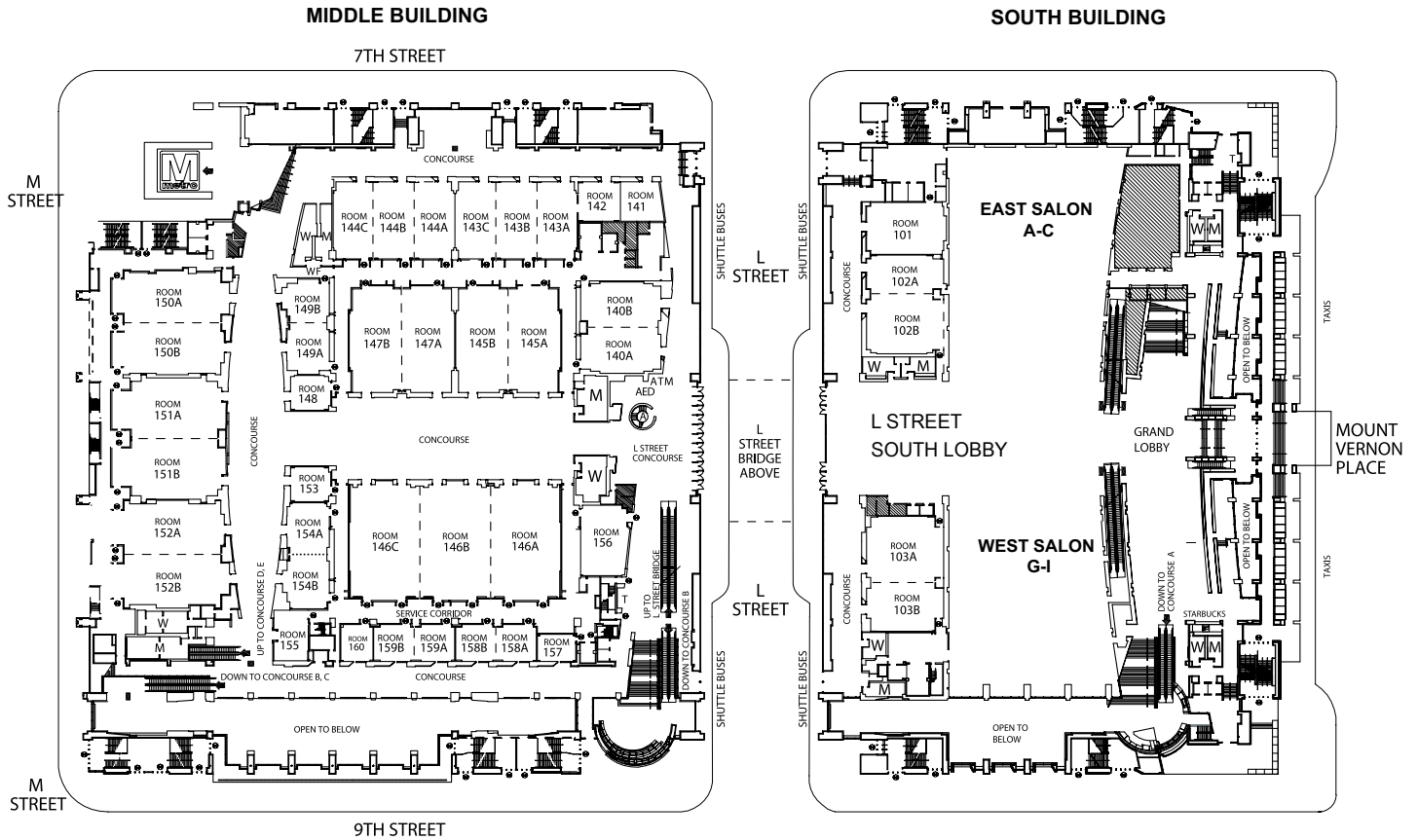

## LEVEL 2

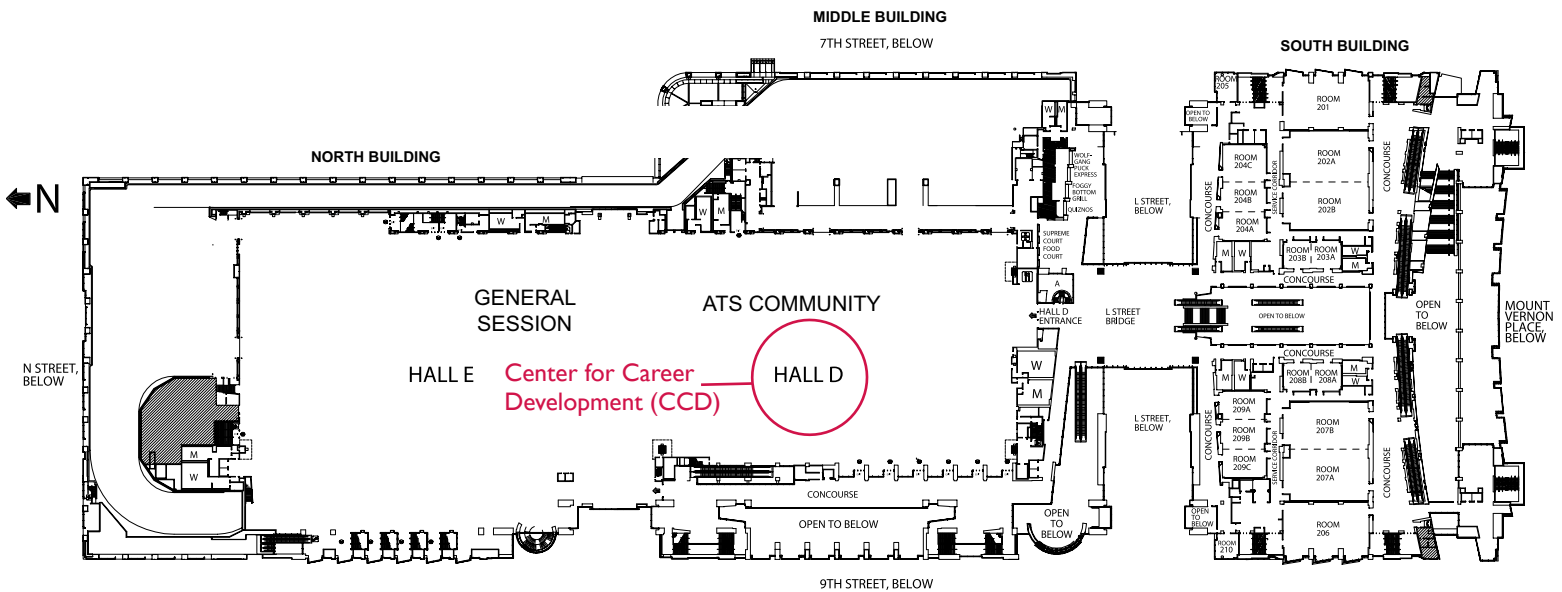

# *The ATS Would Like to Acknowledge its 2017 Corporate Members*



## BENEFACTOR



## PATRON



## SUPPORTER



## FRIEND



*Thank you for your support.*



*We help the world breathe®*  
PULMONARY • CRITICAL CARE • SLEEP

**CORPORATE MEMBERSHIP PROGRAM**  
For more information, please visit [www.thoracic.org](http://www.thoracic.org)